

Signaling units Ø 70

Harmony[®] XVB modular tower lights

Catalog

September 2013



How to find the “Automation and Control” products

> Catalogs

Complete product ranges

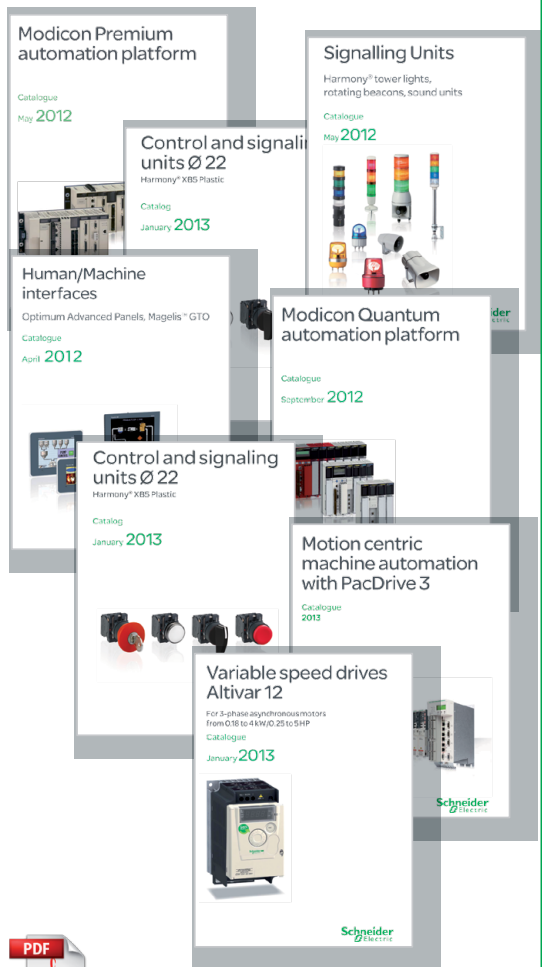

> Essential guides

Selection of the top selling products

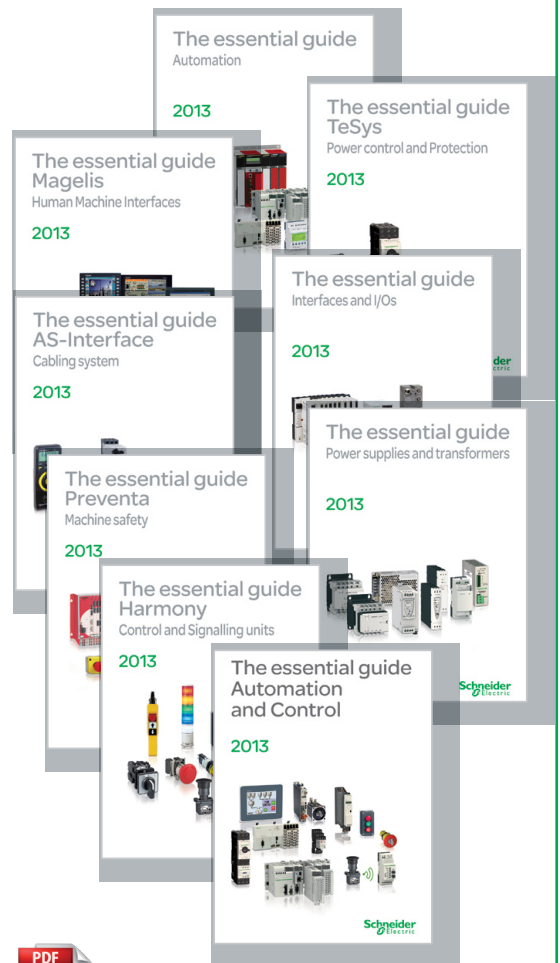

General contents

Harmony® XVB modular tower lights

Selection guide page 2

■ Presentation

□ Illuminated beacons, tower lights for customer assembly page 6

■ References

□ Illuminated beacons, type XVBL page 8

□ Tower lights, type XVBC, for customer assembly, up to 5 units page 11

□ Accessories for XVBL and XVBC page 15

■ How to find the “Automation and Control” products

□ Search, visualize, and download page 16

□ Access product references with adapted tools page 18

□ Compare, select, and compile page 20

□ Check the product status, design your equipment page 21

■ **Product reference index** page 22

Harmony® type XV **Monolithic tower lights**



Type of products	Complete pre-cabled pilot lights, height 55 mm/2.17 in.	Complete miniature beacons	Pre-assembled/pre-cabled tower lights Variable composition tower lights for customer assembly of up to 4 units
Diameter	Ø 25 mm/0.98 in.	Ø 45 mm/1.75 in.	Ø 60 mm/2.36 in.
Degree of protection conforming to IEC 60529	IP 40	IP 40	IP 53 and IP 42 (base mounting) IP 23 (direct aluminium tube mounting, aluminium tube mounting and "L" bracket) IP 53 and IP 42 (aluminium tube mounting and fixing plate) IP 40 (aluminium tube mounting and foldable bracket)
Type of signalling	Steady Flashing "Flash" Sound	– – Yes –	Yes – – With buzzer
Light sources	Incandescent bulb LED bulb Integral LED "Flash" discharge tube Halogen bulb	Yes – – Yes –	– – Yes – –
Colors of illuminated units	<input type="checkbox"/> Green <input type="checkbox"/> Red <input type="checkbox"/> Clear <input type="checkbox"/> Yellow	<input type="checkbox"/> Green <input type="checkbox"/> Red <input type="checkbox"/> Orange <input type="checkbox"/> Blue <input type="checkbox"/> Clear <input type="checkbox"/> Yellow	<input type="checkbox"/> Red <input type="checkbox"/> Green <input type="checkbox"/> Amber <input type="checkbox"/> Blue
Connection	Flying leads, length 360 mm/14.17 in.	Screw clamp terminals	Flying leads, length 500 to 560 mm/19.68 to 22.05 in. for tube mounting according to model. Length 900 mm/35.43 in. for base mounting.
Support panel drilling or cut-out	Ø 22 mm/0.87 in. or Ø 30 mm/1.18 in.	3 x Ø 3.3 mm/0.13 in. or M3	Base mounting: 3 x Ø 5 mm/0.20 in. Direct aluminium tube mounting: Ø 20/0.79 in. Aluminium tube mounting and "L" bracket: 2 x Ø 9/0.35 in. Aluminium tube mounting and fixing plate: 4 x Ø 6/0.24 in. Aluminium tube mounting and foldable bracket: 4 x Ø 6/0.24 in.
Type references	XV1CA	XVDLS	XVG



Type of products	Pre-assembled and pre-cabled tower lights	Pre-assembled and pre-cabled tower lights	Pre-assembled and pre-cabled tower lights	Pre-assembled and pre-cabled USB tower lights
Diameter	Ø 40 mm/1.57 in.	Ø 60 mm/2.36 in.	Ø 100 mm/3.94 in.	Ø 60 mm/2.36 in.
Degree of protection conforming to IEC 60529	IP 54 (flat surface installation) IP 23 (vertical surface installation)	IP 54 (flat surface installation) IP 23 (vertical surface installation)	IP 54 (flat surface installation)	IP 42
Type of signalling	Yes Yes – With buzzer	Yes Yes – With buzzer	Yes Yes – With siren or buzzer	Yes Yes – With buzzer (volume control and alarm type can be set with HMI)
Light sources	– – Yes – –	– – Yes – –	– – Yes – –	– – Yes – –
Colors of illuminated units	<input type="checkbox"/> Red <input type="checkbox"/> Orange <input type="checkbox"/> Green <input type="checkbox"/> Blue <input type="checkbox"/> Clear	<input type="checkbox"/> Red <input type="checkbox"/> Orange <input type="checkbox"/> Green <input type="checkbox"/> Blue <input type="checkbox"/> Clear	<input type="checkbox"/> Red <input type="checkbox"/> Orange <input type="checkbox"/> Green <input type="checkbox"/> Blue <input type="checkbox"/> Clear	Multi-color LEDs (many possible combinations can be set with HMI) <input type="checkbox"/> Red <input type="checkbox"/> Orange <input type="checkbox"/> Green <input type="checkbox"/> Blue
Connection	Flying leads, length 450 mm/17.71 in. to 900 mm/35.43 in. according to model	Flying leads, length 450 mm/17.71 in. to 850 mm/33.46 in. according to model	Flying leads, length 500 mm/19.68 in.	USB power cable: - 300 mm/11.81 in. for tube mounting - 400 mm/15.75 in. for direct mounting
Support panel drilling or cut-out	Mounting on support tube with bracket: 2 x Ø 9 mm/0.35 in. Direct mounting on horizontal support: 3 x Ø 5 mm/0.20 in. Other mounting possibilities with accessories	Mounting on support tube with bracket: 2 x Ø 11 mm/0.43 in. Direct mounting on horizontal support: 3 x Ø 5 mm/0.20 in. Other mounting possibilities with accessories	Direct mounting on horizontal support: - 3 x Ø 6 mm/0.24 in. (without siren) - 3 x Ø 7 mm/0.28 in. (with siren) Other mounting possibilities with accessories	Mounting on support tube with fixing plate: 4 x Ø 6 mm/0.24 in. Direct mounting on horizontal support: 3 x Ø 5 mm/0.20 in.
Type references	XVC4	XVC6	XVC1	XVGU

Harmony® type XV **Modular tower lights**



Type of products	Pre-assembled/pre-cabled tower lights Variable composition tower lights for customer assembly of up to 5 units	Tower lights for customer assembly of up to 5 units.
Diameter	Ø 45 mm/1.77 in.	Ø 60 mm/2.36 in.
Degree of protection conforming to IEC 60529	IP 54 in vertical position (XVM with plastic fixing plate) IP 42 in horizontal position (XVM with metal bracket) IP 40 in other positions (all types of XVM tower lights)	IP 65 for illuminated units IP 54 for audible units IP 55 for flexible mounting option
Type of signalling	Steady Flashing "Flash" Sound	Yes Yes Yes Yes
Light sources	Incandescent bulb LED bulb Integral LED "Flash" discharge tube Halogen bulb	– – Yes – –
Colors of illuminated units	<input type="checkbox"/> Red <input type="checkbox"/> Green <input type="checkbox"/> Orange <input type="checkbox"/> Blue <input type="checkbox"/> Clear	<input type="checkbox"/> Green <input type="checkbox"/> Red <input type="checkbox"/> Orange <input type="checkbox"/> Blue <input type="checkbox"/> White <input type="checkbox"/> Yellow (only for multi-color unit with above colors)
Connection	Flying leads, length 300 mm/11.81 in. or screw terminals	Spring cage connection terminals
Support panel drilling or cut-out	Mounting on bracket: 2 x Ø 9 mm /0.35 in. Mounting on support tube: 4 x Ø 5.5 mm/0.22 in. or M5	Mounting on support tube and adjustable support tube: 4 x Ø 6 mm/0.24 in. Direct mounting and Flexible wall mounting: 3 x Ø 5 mm/0.196 in.
Type references	XVM	XVU

Rotating beacons **Sound solutions**



Type of products	Illuminated beacons Variable composition tower lights for customer assembly of up to 5 units	Pre-cabled rotating beacons	Sirens and electronic alarms
Diameter	Ø 70 mm/2.76 in.	Ø 84 mm/3.31 in. to Ø 130 mm/5.12 in.	–
Degree of protection conforming to IEC 60529	IP 65 (mounted on fixing base XVBZ0●) IP 66 (mounted on base unit)	Ø 84 mm/3.31 in. and Ø 106 mm/4.17 in.: IP 23 (IP 65 with accessory) Ø 120 mm/4.72 in.: IP 23 Ø 130 mm/5.12 in.: IP 66 and IP 67 (depending on voltage)	IP 53 (sirens) IP 54 (electronic alarms)
Type of signalling	Yes Yes Yes Yes	Yes – – Yes	– – – Yes
Light sources	Yes "PROTECTED LED" "PROTECTED LED" Yes –	– "Super Bright" – – Yes	– – – –
Colors of illuminated units	<input type="checkbox"/> Green <input type="checkbox"/> Red <input type="checkbox"/> Orange <input type="checkbox"/> Blue <input type="checkbox"/> Clear <input type="checkbox"/> Yellow	<input type="checkbox"/> Red <input type="checkbox"/> Orange <input type="checkbox"/> Green <input type="checkbox"/> Blue	–
Connection	Screw clamp terminals	Flying leads, length 400 mm/15.75 in. (except XVR08: 500 mm/19.68 in.)	Screw clamp terminals (except XVS14: flying leads, length 500 mm/19.68 in.)
Support panel drilling or cut-out	Mounting on support tube: 4 x Ø 5.5 mm/0.22 in. or M5 Vertical mounting: 3 x Ø 5 mm/0.20 in. or M5 Direct mounting: 2 x Ø 4.5 mm/0.18 in. or M4	Depending on model: – XVR08 (Ø 84 mm/3.31 in.): 3 x Ø 5 mm/0.20 in. – XVR10 (Ø 106 mm/5.12 in.): 3 x Ø 5 mm/0.20 in. – XVR12 (Ø 120 mm/4.72 in.): 3 x Ø 6 mm/0.24 in. – XVR13 (Ø 130 mm/5.12 in.): 3 x Ø 9 mm/0.35 in. – XVR13●●L (Ø 130 mm/5.12 in.): 3 x Ø 7 mm/0.28 in.	3 x Ø 6.5 mm/0.25 in.
Type references	XVBL, XVBC	XVR	XVS

Signaling Units

Modular tower lights

Harmony® type XVB Ø 70

Illuminated beacons, tower lights for customer assembly (up to 5 units)

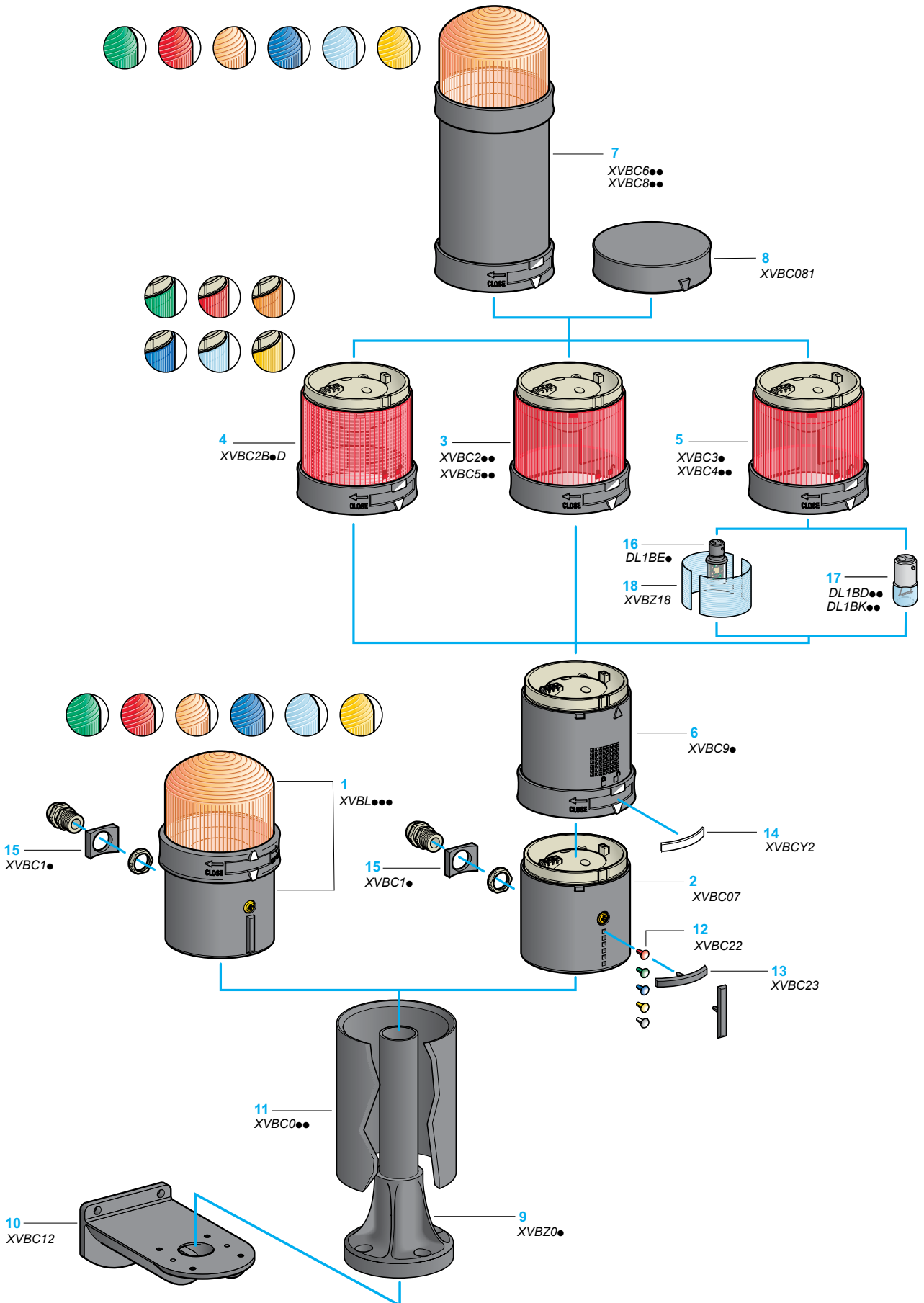

Signaling Units

Modular tower lights

Harmony® type XVB Ø 70

Illuminated beacons, tower lights for customer assembly (up to 5 units)

Presentation

The beacons and tower lights of the Harmony® XVB range are visual or audible signaling units used for indicating, throughout 360° and at a distance, the various states or operation sequences of a machine or installation. Examples: start, stop machine, no material, call technical staff, fault signaling, etc.

Complete illuminated beacon XVBL

Readily assembled **1** with a single illuminated signaling unit:

- steady light (with incandescent bulb or LED),
- flashing light (with incandescent bulb or LED),
- or "flash" (with discharge tube).

The **XVBL** beacons comprise:

- A base unit with a removable terminal block and a bottom or side cable entry.
- One colored illuminated unit (green, red, orange, blue, clear or yellow).

Customer assembled tower light XVBC

Variable composition of 1 to 5 illuminated or audible units that are supplied as separate items for customer assembly. Maximum configuration: 5 units or 4 units + 1 "flash" unit.

The **XVBC** tower lights comprise:

- A base unit with a removable terminal block and bottom or side cable entry **2**.
- 1 to 5 colored illuminated units (green, red, orange, blue, clear or yellow):
 - with integral LED **3**,
 - with integral LED and diffuser **4 (1)**,
 - for incandescent bulbs or base mounted LEDs **5**.
- 1 or 2 audible units **6**.
- A maximum of 1 "flash" discharge unit (5 Joule or 10 Joule) **7**, for mounting on top of the bank.
- A top cover **8** (except when using a "flash" discharge tube).
- The illuminated or audible units stack vertically and are easily locked and unlocked using an integral clamping ring. Electrical connections between each unit are made automatically.
- A light diffuser, pre-fitted in illuminated units XVBC2B•D with a base mounted LED, distributes the light evenly over the lens surface. When using the modular tower lights in bright ambient light conditions, remove the diffuser to improve contrast.
- Connection on the AS-Interface cabling system is possible by ordering a dedicated base unit. For more information on AS-Interface, please see our website www.schneider-electric.com.

Accessories for beacons XVBL and tower lights XVBC

- Fixing base comprising a support tube glued into a plastic fixing plate, for a height beneath the base unit of 80, 380 or 780 mm **9**.
- Fixing plate for mounting on vertical support **10**.
- Support tube concealment cover, height 100, 400 or 800 mm **11**.
- Colored markers **12 (1)**.
- Legend holder with legend **13 (1)**.
- Legends that attach to locking ring of each signaling unit for identification **14**.
- Adaptor and 13P cable gland **15**.
- Base mounted LED **16** or incandescent bulb **17 (2)**.
- Diffuser **18 (3)**.

Mounting, protection and conformity to standards

- Base unit fixed directly onto a panel using 2 screws (IP 66 protection).
- Fixed using a fixing base comprising of an aluminium support tube glued into a plastic fixing plate (IP 65 protection).
- Conformity to EN/IEC 60947-5-1 standard.
- Product certified UL, CSA, CCC and GOST.

Cabling

By means of removable terminal block incorporated in base unit (simplified wiring). The screw and captive cable clamp terminals are protected to prevent any accidental contact with live parts.

(1) These enable the position of the various units (illuminated or audible) to be identified in the event of dismantling the bank.

(2) **Warning:** illuminated units with incandescent bulbs must not be combined with LED illuminated units, due to the risk of overheating. Also, when different units (e.g. steady, flashing,) are combined, the maximum temperature is limited to that of the weaker unit.

(3) The diffuser can only be used with LED illuminated units. Not compatible with units fitted with an incandescent bulb or "flash" discharge tube.

Signaling Units

Modular tower lights

Harmony® type XVBL Ø 70

Illuminated beacons for incandescent bulbs or LEDs
(BA 15d base fitting)



XVBL3●



XVBL4B●

Illuminated beacons with steady light signaling

Description	Light source, to be ordered separately (1)	Color	Reference	Weight kg
Complete unit comprising: - 1 illuminated unit - 1 base unit for direct fixing (IP 66) or tube fixing (IP 65)	Incandescent bulb 7 W max. 250 V max.	Green	XVBL33	0.260
		Red	XVBL34	0.260
		Orange	XVBL35	0.260
		Blue	XVBL36	0.260
		Clear	XVBL37	0.260
		Yellow	XVBL38	0.260

Illuminated beacons with integral flashing light signaling

Description	Light source, to be ordered separately (1)	Color	Reference	Weight kg	
Complete unit comprising: - 1 illuminated unit - 1 base unit for direct fixing (IP 66) or tube fixing (IP 65)	Incandescent bulb 7 W max. ~ 24 V --- 24...48 V	Green	XVBL4B3	0.280	
		Red	XVBL4B4	0.280	
		Orange	XVBL4B5	0.280	
		Blue	XVBL4B6	0.280	
		Clear	XVBL4B7	0.280	
		Yellow	XVBL4B8	0.280	
		Incandescent bulb 7 W max. ~ 48...230 V	Green	XVBL4M3	0.280
			Red	XVBL4M4	0.280
Orange	XVBL4M5		0.280		
Blue	XVBL4M6		0.280		
Clear	XVBL4M7		0.280		
Yellow	XVBL4M8		0.280		

(1) Incandescent bulbs and LEDs, see page 15.

Signaling Units

Modular tower lights

Harmony® type XVBL Ø 70

Illuminated beacons with LED light source

1014075E



XVBL0B●

Illuminated beacons with steady light signaling

Description	Light source	Color	Reference	Weight kg	
Complete unit comprising: - 1 illuminated unit - 1 base unit for direct fixing (IP 66) or tube fixing (IP 65)	LED, included ≈ 24 V	Green	XVBL0B3	0.270	
		Red	XVBL0B4	0.270	
		Orange	XVBL0B5	0.270	
		Blue	XVBL0B6	0.270	
		Clear	XVBL0B7	0.270	
		Yellow	XVBL0B8	0.270	
		LED, included ~ 120 V	Green	XVBL0G3	0.270
			Red	XVBL0G4	0.270
Orange	XVBL0G5		0.270		
Blue	XVBL0G6		0.270		
Clear	XVBL0G7		0.270		
Yellow	XVBL0G8		0.270		
LED, included ~ 230 V	Green		XVBL0M3	0.270	
	Red		XVBL0M4	0.270	
	Orange	XVBL0M5	0.270		
	Blue	XVBL0M6	0.270		
	Clear	XVBL0M7	0.270		
	Yellow	XVBL0M8	0.270		

Protected
LED

PF110455



XVBL1B●

Illuminated beacons with integral flashing light signaling

Description	Light source	Color	Reference	Weight kg	
Complete unit comprising: - 1 illuminated unit - 1 base unit for direct fixing (IP 66) or tube fixing (IP 65)	LED, included ≈ 24 V	Green	XVBL1B3	0.280	
		Red	XVBL1B4	0.280	
		Orange	XVBL1B5	0.280	
		Blue	XVBL1B6	0.280	
		Clear	XVBL1B7	0.280	
		Yellow	XVBL1B8	0.280	
		LED, included ~ 120 V	Green	XVBL1G3	0.280
			Red	XVBL1G4	0.280
Orange	XVBL1G5		0.280		
Blue	XVBL1G6		0.280		
Clear	XVBL1G7		0.280		
Yellow	XVBL1G8		0.280		
LED, included ~ 230 V	Green		XVBL1M3	0.280	
	Red		XVBL1M4	0.280	
	Orange	XVBL1M5	0.280		
	Blue	XVBL1M6	0.280		
	Clear	XVBL1M7	0.280		
	Yellow	XVBL1M8	0.280		

Protected
LED

Signaling Units

Modular tower lights

Harmony® type XVBL Ø 70

Illuminated beacons with “flash” discharge tube



XVBL6B●



XVBL8B●

Illuminated beacons with 5 Joule “flash” discharge tube

Description	Light source	Color	Reference	Weight kg	
Complete unit comprising: - 1 illuminated unit - 1 base unit for direct fixing (IP 66) or tube fixing (IP 65)	Integral “flash” discharge tube ~ 24 V	Green	XVBL6B3	0.440	
		Red	XVBL6B4	0.440	
		Orange	XVBL6B5	0.440	
		Blue	XVBL6B6	0.440	
		Clear	XVBL6B7	0.440	
		Yellow	XVBL6B8	0.440	
		Integral “flash” discharge tube ~ 120 V	Green	XVBL6G3	0.425
			Red	XVBL6G4	0.425
Orange	XVBL6G5		0.425		
Blue	XVBL6G6		0.425		
Clear	XVBL6G7		0.425		
Yellow	XVBL6G8		0.425		
Integral “flash” discharge tube ~ 230 V	Green	XVBL6M3	0.435		
	Red	XVBL6M4	0.435		
	Orange	XVBL6M5	0.435		
	Blue	XVBL6M6	0.435		
	Clear	XVBL6M7	0.435		
	Yellow	XVBL6M8	0.435		

Illuminated beacons with 10 Joule “flash” discharge tube

Description	Light source	Color	Reference	Weight kg
Complete unit comprising: - 1 illuminated unit - 1 base unit for direct fixing (IP 66) or tube fixing (IP 65)	Integral “flash” discharge tube ~ 24 V	Green	XVBL8B3	0.450
		Red	XVBL8B4	0.450
		Orange	XVBL8B5	0.450
		Blue	XVBL8B6	0.450
		Clear	XVBL8B7	0.450
		Yellow	XVBL8B8	0.450
Integral “flash” discharge tube ~ 120 V	Green	XVBL8G3	0.460	
	Red	XVBL8G4	0.460	
	Orange	XVBL8G5	0.460	
	Blue	XVBL8G6	0.460	
	Clear	XVBL8G7	0.460	
	Yellow	XVBL8G8	0.460	
Integral “flash” discharge tube ~ 230 V	Green	XVBL8M3	0.460	
	Red	XVBL8M4	0.460	
	Orange	XVBL8M5	0.460	
	Blue	XVBL8M6	0.460	
	Clear	XVBL8M7	0.460	
	Yellow	XVBL8M8	0.460	

For use with base unit XVBC●●: see page 14

Signaling Units

Modular tower lights

Harmony® type XVBC Ø 70

Tower lights for customer assembly (up to 5 units)

Illuminated units for incandescent bulbs or LEDs (BA 15d base fitting)



XVBC3●



XVBC4●●

Illuminated units with steady light signaling

Description	Light source, to be ordered separately (1)	Color	Reference	Weight kg
Illuminated units	Incandescent bulb 7 W max. 250 V max. or LED	Green	XVBC33	0.140
		Red	XVBC34	0.140
		Orange	XVBC35	0.140
		Blue	XVBC36	0.140
		Clear	XVBC37	0.140
		Yellow	XVBC38	0.140

Illuminated units with integral flashing light signaling

Description	Light source, to be ordered separately (1)	Color	Reference	Weight kg	
Illuminated units	Incandescent bulb 7 W max. ~ 24 V ~ 24...48 V or LED	Green	XVBC4B3	0.160	
		Red	XVBC4B4	0.160	
		Orange	XVBC4B5	0.160	
		Blue	XVBC4B6	0.160	
		Clear	XVBC4B7	0.160	
		Yellow	XVBC4B8	0.160	
		Incandescent bulb 7 W max. ~ 48...230 V or LED	Green	XVBC4M3	0.160
			Red	XVBC4M4	0.160
	Orange		XVBC4M5	0.160	
	Blue		XVBC4M6	0.160	
	Clear		XVBC4M7	0.160	
	Yellow		XVBC4M8	0.160	

(1) Incandescent bulbs and LEDs, see page 15.

Signaling Units

Modular tower lights

Harmony® type XVBC Ø 70

Tower lights for customer assembly (up to 5 units)

Illuminated units with integral LED

For use with base unit XVBC●●: see page 14



XVBC2●●



XVBC5●●

Illuminated units with steady light signaling

Description	Voltage	Color	Reference	Weight kg
Illuminated units with integral LED	≈ 24 V	Green	XVBC2B3 (1)	0.150
		Red	XVBC2B4 (1)	0.150
		Orange	XVBC2B5 (1)	0.150
		Blue	XVBC2B6 (1)	0.150
		Clear	XVBC2B7 (1)	0.150
		Yellow	XVBC2B8 (1)	0.150
	~ 120 V	Green	XVBC2G3	0.150
		Red	XVBC2G4	0.150
		Orange	XVBC2G5	0.150
		Blue	XVBC2G6	0.150
		Clear	XVBC2G7	0.150
		Yellow	XVBC2G8	0.150
	~ 230 V	Green	XVBC2M3	0.150
		Red	XVBC2M4	0.150
		Orange	XVBC2M5	0.150
Blue		XVBC2M6	0.150	
Clear		XVBC2M7	0.150	
Yellow		XVBC2M8	0.150	

Protected LED

Illuminated units with integral flashing light signaling

Description	Voltage	Color	Reference	Weight kg
Illuminated units with integral LED	≈ 24 V	Green	XVBC5B3	0.170
		Red	XVBC5B4	0.170
		Orange	XVBC5B5	0.170
		Blue	XVBC5B6	0.170
		Clear	XVBC5B7	0.170
		Yellow	XVBC5B8	0.170
	~ 120 V	Green	XVBC5G3	0.170
		Red	XVBC5G4	0.170
		Orange	XVBC5G5	0.170
		Blue	XVBC5G6	0.170
		Clear	XVBC5G7	0.170
		Yellow	XVBC5G8	0.170
	~ 230 V	Green	XVBC5M3	0.170
		Red	XVBC5M4	0.170
		Orange	XVBC5M5	0.170
Blue		XVBC5M6	0.170	
Clear		XVBC5M7	0.170	
Yellow		XVBC5M8	0.170	

Protected LED

(1) To order an illuminated unit with integral LED pre-fitted with light diffuser XVZ18, add the letter "D" to the end of the reference. Example: XVBC2B3D.

Signaling Units

Modular tower lights

Harmony® type XVBC Ø 70

Tower lights for customer assembly (up to 5 units)

Illuminated units with integral “flash” discharge tube

For use with base unit XVBC●●: see page 14

821006



XVBC6●●

821006



XVBC8●●

Illuminated units with 5 Joule “flash” discharge tube (1)

Description	Light source	Color	Reference	Weight kg	
Illuminated units	Integral “flash” discharge tube ≈ 24 V	Green	XVBC6B3	0.295	
		Red	XVBC6B4	0.295	
		Orange	XVBC6B5	0.295	
		Blue	XVBC6B6	0.295	
		Clear	XVBC6B7	0.295	
		Yellow	XVBC6B8	0.295	
		Integral “flash” discharge tube ~ 120 V	Green	XVBC6G3	0.280
			Red	XVBC6G4	0.280
	Orange		XVBC6G5	0.280	
	Blue		XVBC6G6	0.280	
	Clear		XVBC6G7	0.280	
	Yellow		XVBC6G8	0.280	
	Integral “flash” discharge tube ~ 230 V	Green	XVBC6M3	0.290	
		Red	XVBC6M4	0.290	
		Orange	XVBC6M5	0.290	
		Blue	XVBC6M6	0.290	
		Clear	XVBC6M7	0.290	
		Yellow	XVBC6M8	0.290	

Illuminated units with 10 Joule “flash” discharge tube (1)

Description	Light source	Color	Reference	Weight kg	
Illuminated units	Integral “flash” discharge tube ≈ 24 V	Green	XVBC8B3	0.305	
		Red	XVBC8B4	0.305	
		Orange	XVBC8B5	0.305	
		Blue	XVBC8B6	0.305	
		Clear	XVBC8B7	0.305	
		Yellow	XVBC8B8	0.305	
		Integral “flash” discharge tube ≈ 48 V	Orange	XVBC8E5	0.315
	Integral “flash” discharge tube ~ 120 V	Green	XVBC8G3	0.315	
		Red	XVBC8G4	0.315	
		Orange	XVBC8G5	0.315	
		Blue	XVBC8G6	0.315	
		Clear	XVBC8G7	0.315	
		Yellow	XVBC8G8	0.315	
	Integral “flash” discharge tube ~ 230 V	Green	XVBC8M3	0.315	
		Red	XVBC8M4	0.315	
		Orange	XVBC8M5	0.315	
		Blue	XVBC8M6	0.315	
		Clear	XVBC8M7	0.315	
		Yellow	XVBC8M8	0.315	

(1) **Warning:** illuminated units with a “flash” discharge tube are not suitable for steady light signaling due to the heat generated.

Signaling Units

Modular tower lights

Harmony® type XVBC Ø 70

Tower lights for customer assembly (up to 5 units)

Audible units, base units, cover, accessories

821007



XVBC9●

Audible units			
Description	Characteristics	Reference	Weight kg
Buzzer, 90 dB at 1 m Adjustable with microswitch: - from 70 to 90 dB - continuous or intermittent tone	≈ 12...48 V	XVBC9B	0.170
	≈ 120...230 V	XVBC9M	0.180

1013965E



XVBC07

Base units - for direct (IP 66) or tube fixing				
Description	For use with	Type	Reference	Weight kg
Base unit + cover with bottom or side cable entry	Modular tower lights without "flash" discharge tube unit	Standard	XVBC21	0.190
Base unit only with bottom or side cable entry	Modular tower lights with "flash" discharge tube unit	Standard	XVBC07	0.160
Base unit + cover with side cable entry	All types of modular tower lights	AS-Interface (1)	XVBC21A	-
Base unit + cover with bottom entry, pre-cabled (length 1 m) and fitted with M12 end connector	All types of modular tower lights	AS-Interface (1)	XVBC21B	-

1078308E



XVBC081

Accessories specific to tower lights XVBC			
Description	Application	Unit reference	Weight kg
Cover only	For use with XVBC2, XVBC3, XVBC4, XVBC5 and XVBC9	XVBC081	0.030
Set of 6 colored markers	For identification of the position of units in the event of dismantling the modular tower light	XVBC22	0.001
Set of 5 legend holders	For identification of stacked units on base unit	XVBC23	0.002
Sheet of 85 legends	For use with base unit legend holder XVBC23	XVBCY1	0.005
Sheet of 52 legends	For identification of stacked units, used on locking ring	XVBCY2	0.005
Adaptor for side entry through base unit	With 13P cable gland	XVBC14	0.015
SIS labelling software (in English, French, German, Italian and Spanish)	For creating legends	XBY2U	0.100
Light diffuser, clear plastic (Sold in boxes)	Only for use with LED illuminated units (all colors) One box allows to equip 5 illuminated units.	XVBZ18	0.080

DF54420

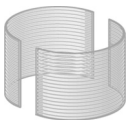

XVBZ18

(1) For further information on AS-Interface connections, refer to our "Industrial communication in machines and installations" catalog.

Signaling Units

Modular tower lights

Harmony® type XVB Ø 70

Illuminated beacons, tower lights for customer assembly (up to 5 units)

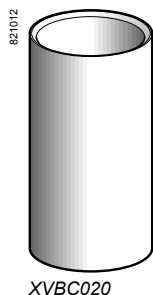

DL1B●●/DL1BK●●

Accessories common to beacons XVB and tower lights XVC

Description	Height under base unit (mm)	Color	Reference	Weight kg
Fixing bases comprising Ø 25 mm aluminium support tube glued into a black plastic fixing plate (IP 65)	80	Black aluminium	XVBZ02	0.110
	380	Aluminium	XVBZ02A	0.110
		Black aluminium	XVBZ03	0.200
	780	Aluminium	XVBZ03A	0.200
		Black aluminium	XVBZ04	0.325
	Aluminium	XVBZ04A	0.325	

Description	For use with	Material	Reference	Weight kg
Support tube concealment cover	Support tubes XVBZ02, XVBZ02A	ABS	XVC020	0.080
	Support tubes XVBZ03, XVBZ03A	ABS	XVC030	0.305
	Support tubes XVBZ04, XVBZ04A	ABS	XVC040	0.610

Description	For use with	Material	Reference	Weight kg
Ø 25 mm aluminium support tube	Fixing plate XVBZ01 (to be glued into the plastic fixing plate)	Plastic	XVBZ14	0.690

Fixing plate for use on horizontal support	Ø 25 mm aluminium support tube	Plastic	XVBZ01	0.050
--	--------------------------------	---------	--------	-------

Fixing plate for use on vertical support	Base unit (direct mounting), fixing plate XVBZ01 or fixing bases XVBZ0●	Zamak	XVC12	0.380
--	---	-------	-------	-------

Description	Characteristics	Sold in lots of	Unit reference	Weight kg	
Incandescent bulbs (1) BA 15d base fitting	12 V	7 W	10	DL1BEJ	0.090
	24 V	6.5 W	10	DL1BEB	0.090
	48 V	6 W	10	DL1BEE	0.090
	120 V	7 W	10	DL1BEG	0.090
	230 V	7 W	10	DL1BEM	0.090

Description	Characteristics	Sold in lots of	Unit reference	Weight kg		
LEDs (1) BA 15d base fitting	~ 24 V	White	1	DL1BDB1	0.015	
		Green	1	DL1BDB3	0.015	
		Red	1	DL1BDB4	0.015	
		Orange	1	DL1BDB5	0.015	
		Blue	1	DL1BDB6	0.015	
		Yellow	1	DL1BDB8	0.015	
		~ 120 V	White	1	DL1BDG1	0.015
			Green	1	DL1BDG3	0.015
	Red		1	DL1BDG4	0.015	
	Orange		1	DL1BDG5	0.015	
	Blue		1	DL1BDG6	0.015	
	Yellow		1	DL1BDG8	0.015	
	~ 230 V		White	1	DL1BDM1	0.015
			Green	1	DL1BDM3	0.015
		Red	1	DL1BDM4	0.015	
		Orange	1	DL1BDM5	0.015	
		Blue	1	DL1BDM6	0.015	
		Yellow	1	DL1BDM8	0.015	

Description	Characteristics	Sold in lots of	Unit reference	Weight kg		
Flashing LEDs (1) BA 15d base fitting	~ 24 V	White	1	DL1BKB1	0.015	
		Green	1	DL1BKB3	0.015	
		Red	1	DL1BKB4	0.015	
		Orange	1	DL1BKB5	0.015	
		Blue	1	DL1BKB6	0.015	
		Yellow	1	DL1BKB8	0.015	
		~ 120 V	White	1	DL1BKG1	0.015
			Green	1	DL1BKG3	0.015
	Red		1	DL1BKG4	0.015	
	Orange		1	DL1BKG5	0.015	
	Blue		1	DL1BKG6	0.015	
	Yellow		1	DL1BKG8	0.015	
	~ 230 V		White	1	DL1BKM1	0.015
			Green	1	DL1BKM3	0.015
		Red	1	DL1BKM4	0.015	
		Orange	1	DL1BKM5	0.015	
		Blue	1	DL1BKM6	0.015	
		Yellow	1	DL1BKM8	0.015	

(1) **Warning:** illuminated units with incandescent bulbs must not be combined with LED illuminated units, due to the risk of overheating. Also, when different units (e.g. steady, flashing...) are combined, the maximum temperature is limited to that of the weaker unit.

Search, visualize, and download

Use your tablet or your PC to quickly access detailed and comprehensive information on our products



Tablets

Application name: "Automation Library by Schneider Electric"

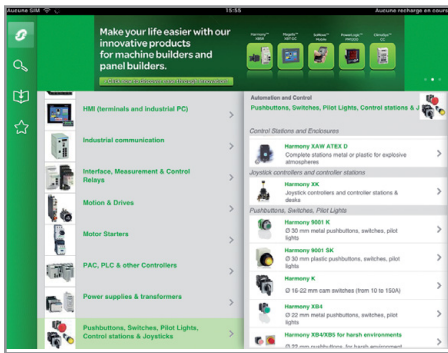

Product ranges displayed by function

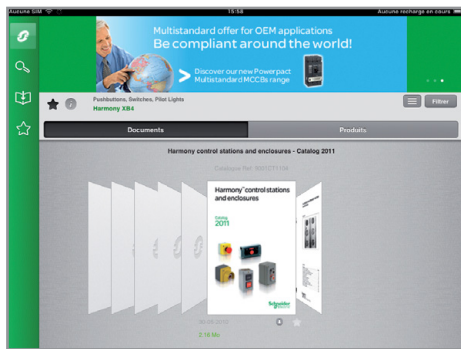
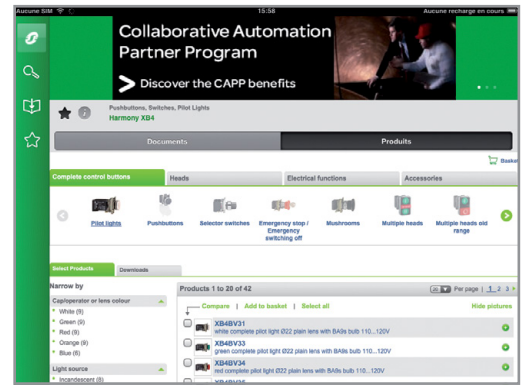

Dynamic catalogs (hyperlinks, video, ...)

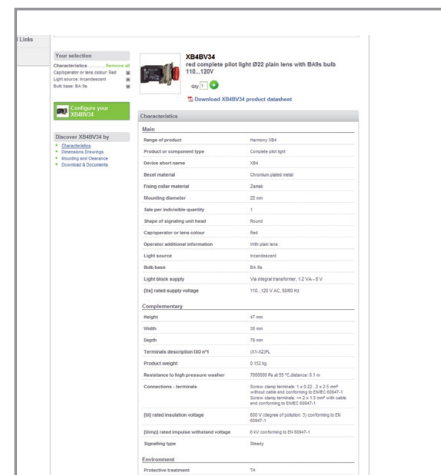

Product selector: dynamic filters to get easily your part number



Personal computer

Path: www.schneider-electric.com > **Products and Services** > Automation and control > Product offer

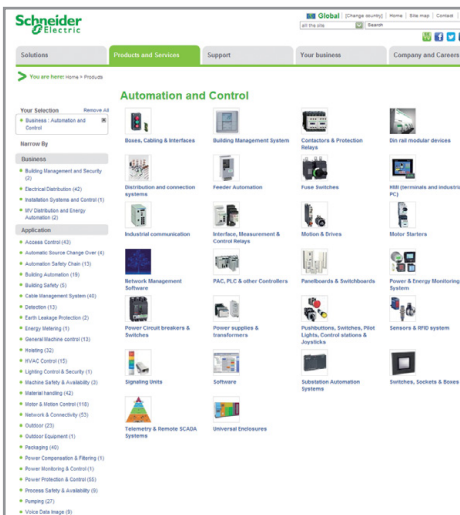

Product ranges displayed by function

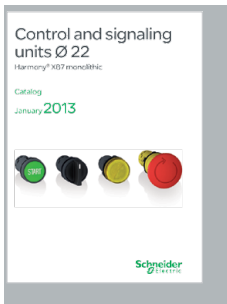
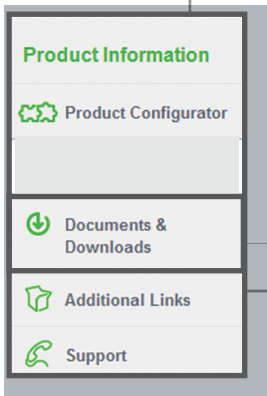
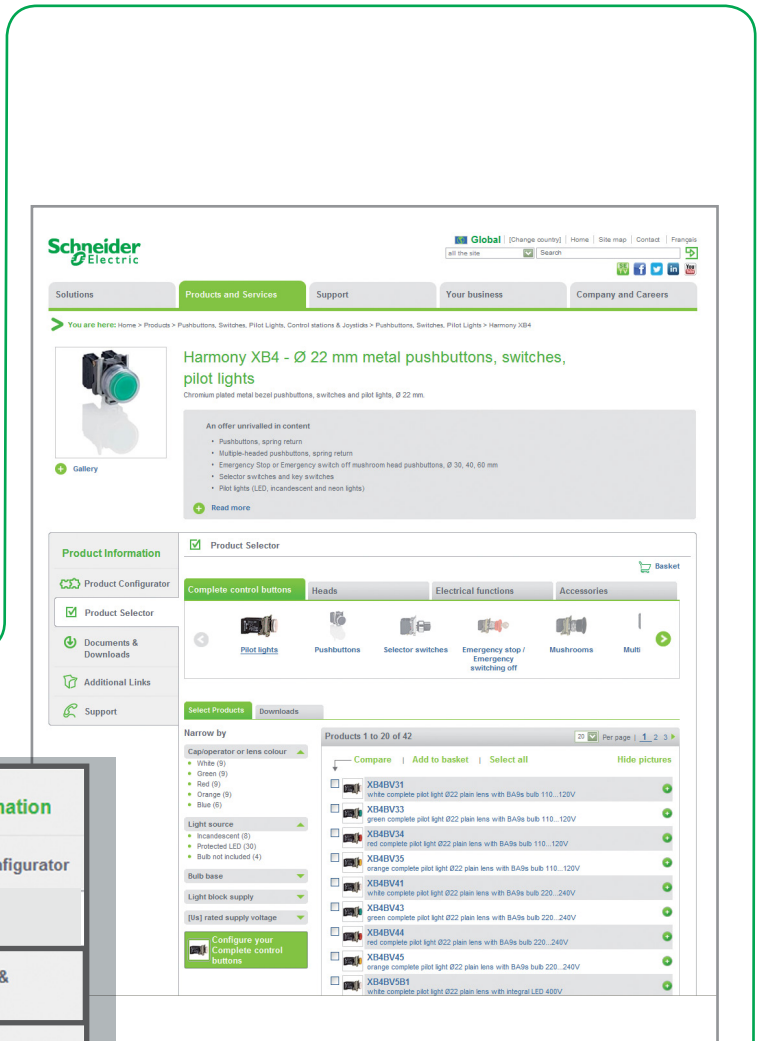

Dynamic catalogs (hyperlinks, video, ...)

Product selector: dynamic filters to get easily your part number

Access product references with adapted tools



Path: www.schneider-electric.com > **Products and Services** > Automation and control > ... > Product offer

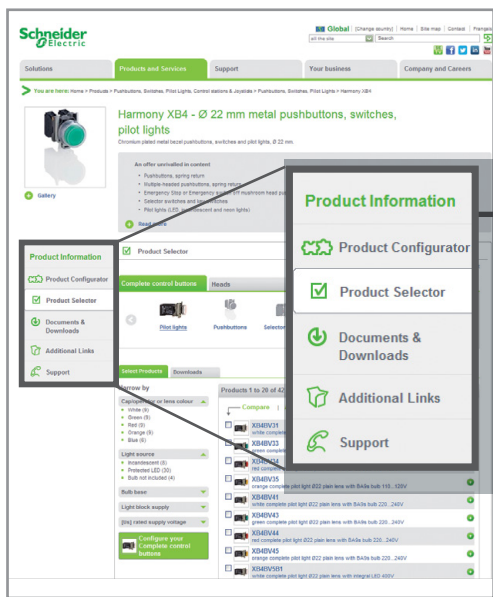

Graphic product configurator
Select the right product with just a few clicks

Dynamic product selector
Visualize product characteristics and dimensions

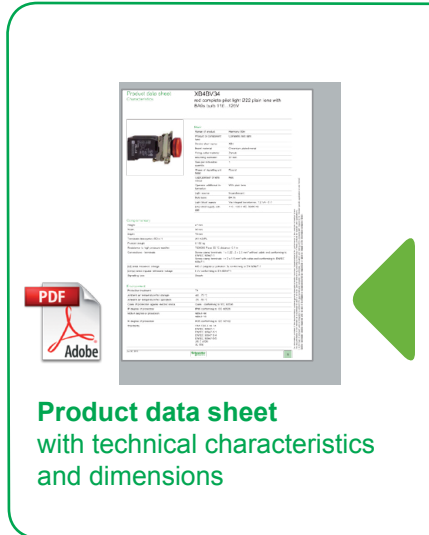
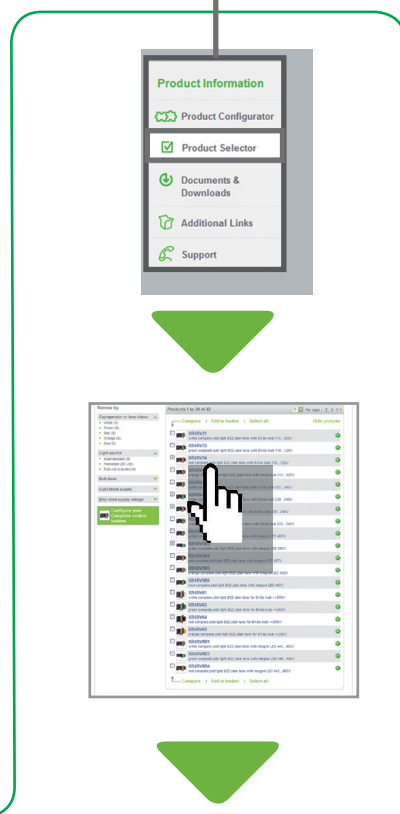
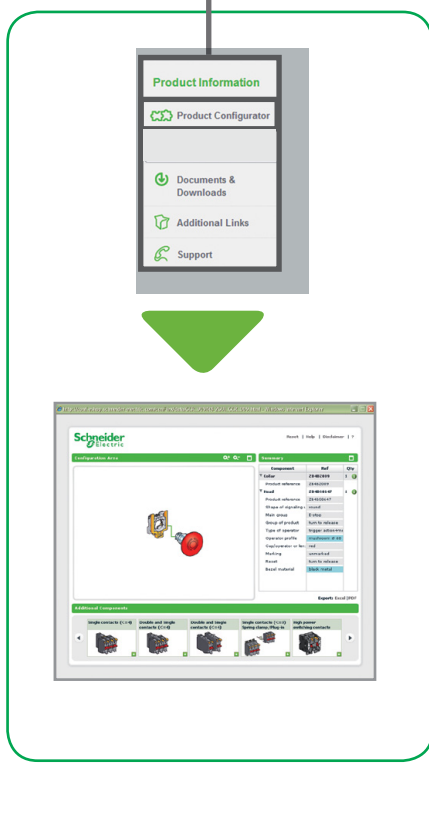

Compare, select, and compile



Path: www.schneider-electric.com > **Products and Services** > Automation and control > ... > Harmony XB4*

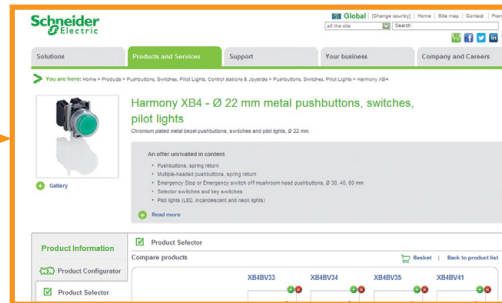
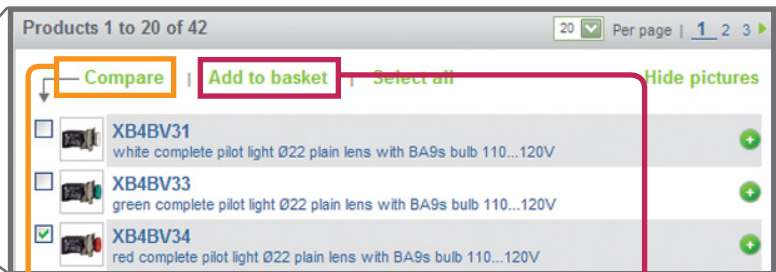

Compare
technical
characteristics

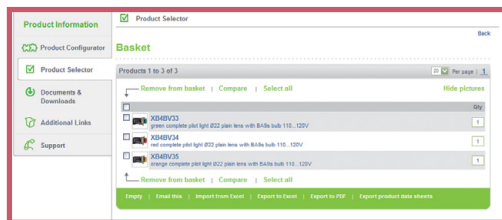

Select
and store
your products
into
the basket



Compile
data sheets
in a unique
document

* Example of research on a product

Check the product status, design your equipment



Path: www.schneider-electric.com > **Support** > Product Substitution Tool

Path: www.schneider-electric.com > **Support** > CAD files

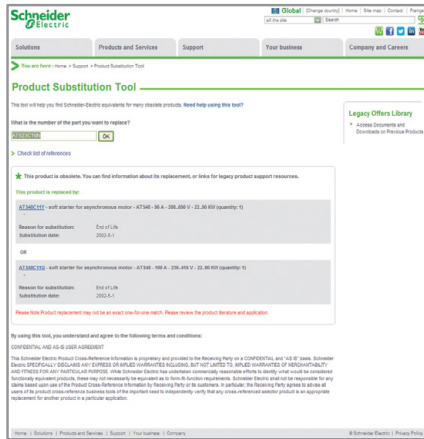
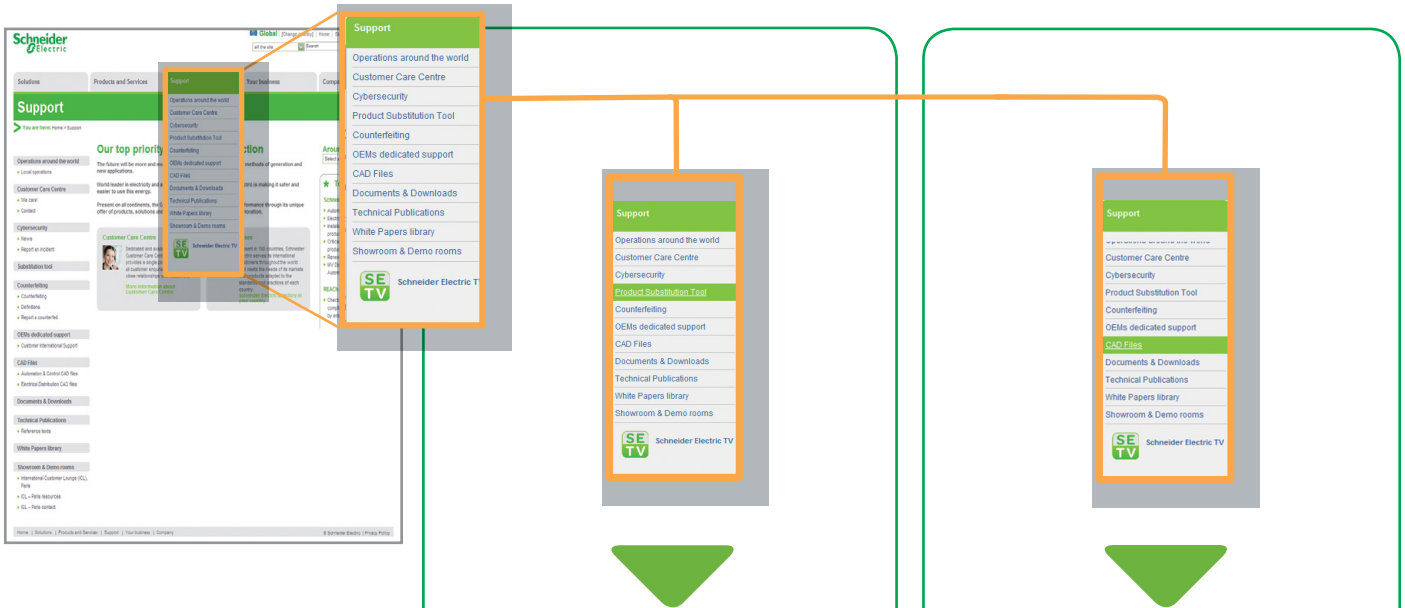

Product status: indicate whether the product is still commercialized. Otherwise, the tool suggests a product substitution.

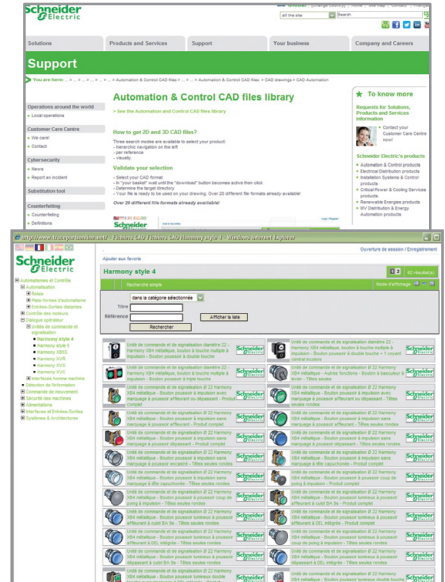

CAD files: available in various formats they will be easily integrated into your installation design software.

Please note that references to products and services are just examples.

D							
DL1BDB1	15	XVBC2B6	12	XVBC6G4	13	XVBL0B7	9
DL1BDB3	15	XVBC2B7	12	XVBC6G5	13	XVBL0B8	9
DL1BDB4	15	XVBC2B8	12	XVBC6G6	13	XVBL0G3	9
DL1BDB5	15	XVBC2G3	12	XVBC6G7	13	XVBL0G4	9
DL1BDB6	15	XVBC2G4	12	XVBC6G8	13	XVBL0G5	9
DL1BDB8	15	XVBC2G5	12	XVBC6M3	13	XVBL0G6	9
DL1BDG1	15	XVBC2G6	12	XVBC6M4	13	XVBL0G7	9
DL1BDG3	15	XVBC2G7	12	XVBC6M5	13	XVBL0G8	9
DL1BDG4	15	XVBC2G8	12	XVBC6M6	13	XVBL0M3	9
DL1BDG5	15	XVBC2M3	12	XVBC6M7	13	XVBL0M4	9
DL1BDG6	15	XVBC2M4	12	XVBC6M8	13	XVBL0M5	9
DL1BDG8	15	XVBC2M5	12	XVBC07	14	XVBL0M6	9
DL1BDM1	15	XVBC2M6	12	XVBC8B3	13	XVBL0M7	9
DL1BDM3	15	XVBC2M7	12	XVBC8B4	13	XVBL0M8	9
DL1BDM4	15	XVBC2M8	12	XVBC8B5	13	XVBL1B3	9
DL1BDM5	15	XVBC4B3	11	XVBC8B6	13	XVBL1B4	9
DL1BDM6	15	XVBC4B4	11	XVBC8B7	13	XVBL1B5	9
DL1BDM8	15	XVBC4B5	11	XVBC8B8	13	XVBL1B6	9
DL1BEB	15	XVBC4B6	11	XVBC8E5	13	XVBL1B7	9
DL1BEE	15	XVBC4B7	11	XVBC8G3	13	XVBL1B8	9
DL1BEG	15	XVBC4B8	11	XVBC8G4	13	XVBL1G3	9
DL1BEJ	15	XVBC4M3	11	XVBC8G5	13	XVBL1G4	9
DL1BEM	15	XVBC4M4	11	XVBC8G6	13	XVBL1G5	9
DL1BKB1	15	XVBC4M5	11	XVBC8G7	13	XVBL1G6	9
DL1BKB3	15	XVBC4M6	11	XVBC8G8	13	XVBL1G7	9
DL1BKB4	15	XVBC4M7	11	XVBC8M3	13	XVBL1G8	9
DL1BKB5	15	XVBC4M8	11	XVBC8M4	13	XVBL1M3	9
DL1BKB6	15	XVBC5B3	12	XVBC8M5	13	XVBL1M4	9
DL1BKB8	15	XVBC5B4	12	XVBC8M6	13	XVBL1M5	9
DL1BKG1	15	XVBC5B5	12	XVBC8M7	13	XVBL1M6	9
DL1BKG3	15	XVBC5B6	12	XVBC8M8	13	XVBL1M7	9
DL1BKG4	15	XVBC5B7	12	XVBC9B	14	XVBL1M8	9
DL1BKG5	15	XVBC5B8	12	XVBC9M	14	XVBL4B3	8
DL1BKG6	15	XVBC5G3	12	XVBC14	14	XVBL4B4	8
DL1BKG8	15	XVBC5G4	12	XVBC21	14	XVBL4B5	8
DL1BKM1	15	XVBC5G5	12	XVBC21A	14	XVBL4B6	8
DL1BKM3	15	XVBC5G6	12	XVBC21B	14	XVBL4B7	8
DL1BKM4	15	XVBC5G7	12	XVBC22	14	XVBL4B8	8
DL1BKM5	15	XVBC5G8	12	XVBC23	14	XVBL4M3	8
DL1BKM6	15	XVBC5M3	12	XVBC33	11	XVBL4M4	8
DL1BKM8	15	XVBC5M4	12	XVBC34	11	XVBL4M5	8
		XVBC5M5	12	XVBC35	11	XVBL4M6	8
		XVBC5M6	12	XVBC36	11	XVBL4M7	8
		XVBC5M7	12	XVBC37	11	XVBL4M8	8
		XVBC5M8	12	XVBC38	11	XVBL6B3	10
X		XVBC6B3	13	XVBC081	14	XVBL6B4	10
XBY2U	14	XVBC6B4	13	XVBCY1	14	XVBL6B5	10
XVBC020	15	XVBC6B5	13	XVBCY2	14	XVBL6B6	10
XVBC030	15	XVBC6B6	13	XVBL0B3	9	XVBL6B7	10
XVBC040	15	XVBC6B7	13	XVBL0B4	9	XVBL6B8	10
XVBC2B3	12	XVBC6B8	13	XVBL0B5	9	XVBL6G3	10
XVBC2B4	12	XVBC6G3	13	XVBL0B6	9		
XVBC2B5	12						