

# IS

## Rectangular Coverage/Mounted in Pairs

### DESIGN FEATURES

- Effective wherever rectangular pattern is required
- High energy efficiency
- Large unimpeded openings
- Excellent clog resistance
- Mounted in opposing pairs
- Male connection

### SPRAY CHARACTERISTICS

- Pattern widths of 18" to 120" can be achieved
- Good distribution with pressures as low as 0.5 psi
- Thick bands of droplets from opposing pairs intersect and fall uniformly

**Spray pattern:** Rectangular

**Spray angle:** See Pattern Width and Coverage Chart

**Flow rates:** 0.5 to 164 gpm per pair

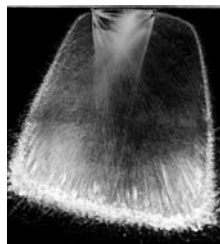
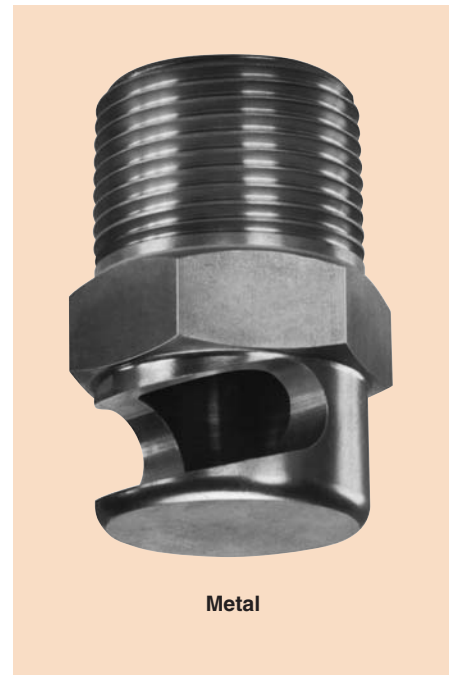

Rectangular Spray

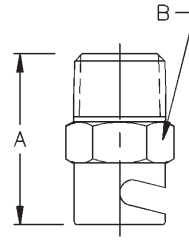
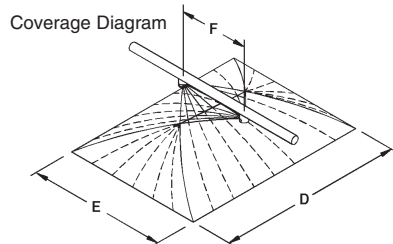

Metal

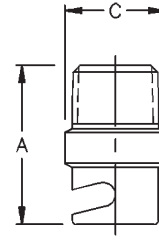

Plastic

Dimensions are approximate. Check with BETE for critical dimension applications.

### IS Flow Rates and Dimensions

Rectangular Spray Pattern, 1/16" to 1 1/2" Pipe Sizes

Male Pipe Size	Nozzle Number	K Factor	GALLONS PER MINUTE PER PAIR @ PSI										Dim. (in.)			Wt. (oz.) Metal/Plas.	
			0.5 PSI	1 PSI	2 PSI	3 PSI	4 PSI	6 PSI	8 PSI	10 PSI	15 PSI	20 PSI	A	B	C		
1/16	IS2	0.71	0.50	0.71	1.0	1.2	1.4	1.7	2.0	2.2	2.7	3.2	0.75	0.31	0.38	0.13	0.06
	IS3	1.06	0.75	1.1	2.0	1.8	2.1	2.6	3.0	3.4	4.1	4.7					
1/8	IS4	1.41	1.0	1.4	2.0	2.4	2.8	3.5	4.0	4.5	5.5	6.3	0.88	0.44	0.50	1.0	0.25
	IS6	2.12	1.5	2.1	3.0	3.7	4.2	5.2	6.0	6.7	8.2	9.5					
1/4	IS8	2.83	2.0	2.8	4.0	4.9	5.7	6.9	8.0	8.9	11	13	1.06	0.56	0.62	1.5	0.38
	IS10	3.54	2.5	3.5	5.0	6.1	7.1	8.7	10	11	14	16					
3/8	IS12	4.24	3.0	4.2	6.0	7.3	8.5	10	12	13	16	19	1.25	0.69	0.75	2.0	0.5
	IS14	4.95	3.5	4.9	7.0	8.6	9.9	12	14	16	19	22					
	IS16	5.66	4.0	5.7	8.0	9.8	11	14	16	18	22	25					
1/2	IS20	7.07	5.0	7.1	10	12	14	17	20	22	27	32	1.50	0.88	0.88	3.0	1.0
	IS24	8.49	6.0	8.5	12	15	17	21	24	27	33	38					
	IS28	9.90	7.0	9.9	14	17	20	24	28	31	38	44					
3/4	IS32	11.3	8.0	11	16	20	23	28	32	36	44	51	1.75	1.13	1.13	6.0	1.5
	IS40	14.1	10	14	20	24	28	35	40	45	55	63					
	IS48	17.0	12	17	24	29	34	42	48	54	66	76					
1	IS56	19.8	14	20	28	34	40	48	56	63	77	89	2.19	1.38	1.38	8.0	2.0
	IS64	22.6	16	23	32	39	45	55	64	72	88	101					
1 1/4	IS72	25.5	18	25	36	44	51	62	72	80	99	114	2.50	1.75	1.75	12	3.0
	IS80	28.3	20	28	40	49	57	69	80	89	110	126					
1 1/2	IS88	31.1	22	31	44	54	62	76	88	98	120	139	3.00	2.00	2.00	20	5.0
	IS96	33.9	24	34	48	59	68	83	96	107	131	152					
	IS104	36.8	26	37	52	64	74	90	104	116	142	164					

### Coverage

12" Mounting Height

Spacing (in.) F	Approx. Cover. (in.) @ PSI							
	1 PSI		2 PSI		4 PSI		8 PSI	
	D	E	D	E	D	E	D	E
3	24	18	34	26	60	30	72	30
4	20	14	32	18	42	30	46	36
5	30	18	42	22	60	36	78	42
6	26	12	36	20	54	24	60	24
8	36	12	60	30	84	36	88	42
10	42	12	60	20	66	24	90	26
12	30	18	48	20	66	24	90	38
14	48	14	60	18	88	20	108	24
16	36	14	48	18	72	24	120	38

$$\text{Flow Rate (GPM)} = K \sqrt{\text{PSI}}$$

Standard Materials: Brass, 303 Stainless Steel, 316 Stainless Steel and PVC.

SPECIAL PURPOSE

TO ORDER: specify pipe size, connection type, nozzle number, and material.