

# VACUUM PUMP P5010

COAX® — THE NEXT DIMENSION IN VACUUM TECHNOLOGY

Profit from new vacuum technology



***Patented  
COAX® push-in  
technology***

***Efficient use  
of energy***

***Outstanding  
performance***

***Slim and  
modular design***

**PIAB**  
Innovators in  
Vacuum Technology

[www.piab.com](http://www.piab.com)

# P5010 – A sustainable solution

*The economical and environmental friendly P5010 is designed for automated vacuum handling applications with robots or dedicated machines. It is developed for requirements found in industries such as plastic, automotive, consumer goods, graphic and glass.*

*The heart of P5010 is a new patented COAX® vacuum cartridge based on a push-in principle. The push-in design facilitates inserts and removals which saves time and money during service or maintenance.*



## Your benefits

- » **Economical and environmentally friendly** – Air saving options and COAX® technology guarantee a minimum of energy usage.
- » **Excellent performance** – High vacuum flow, fast response and an efficient blow-off function.
- » **Reliable use** – P5010 can preserve the vacuum performance even if a sudden pressure drop occurs.
- » **Low weight** – Weight optimized design makes P5010 suitable to mount close to point of vacuum on devices such as robot arms.
- » **Easy to install** – Slim and compact design with several mounting options.
- » **Flexible** – easy to change options fits the needs of your application.
- » **Easy settings** – Adjustment of vacuum switch points and display units is very simple (AVM™2).
- » **Safety** – Safety functions (AVM™2) prevents parts from being dropped during an E-stop or system failure.

The unsurpassed vacuum performance with COAX® technology, provides the highest achievable vacuum performance in relation to energy consumption. Choosing P5010, at a time when reduced carbon footprint and energy conservation is “top-of-mind”, is a great step towards more environmental-friendly production systems and plants. In addition to the energy efficient COAX® technology, The modular P5010 design can be equipped with optional built-in air-saving (ES) functions, which minimize the air consumption to almost nothing.



# ion for vacuum automation

Configure your own P5010 – for optimal performance and function

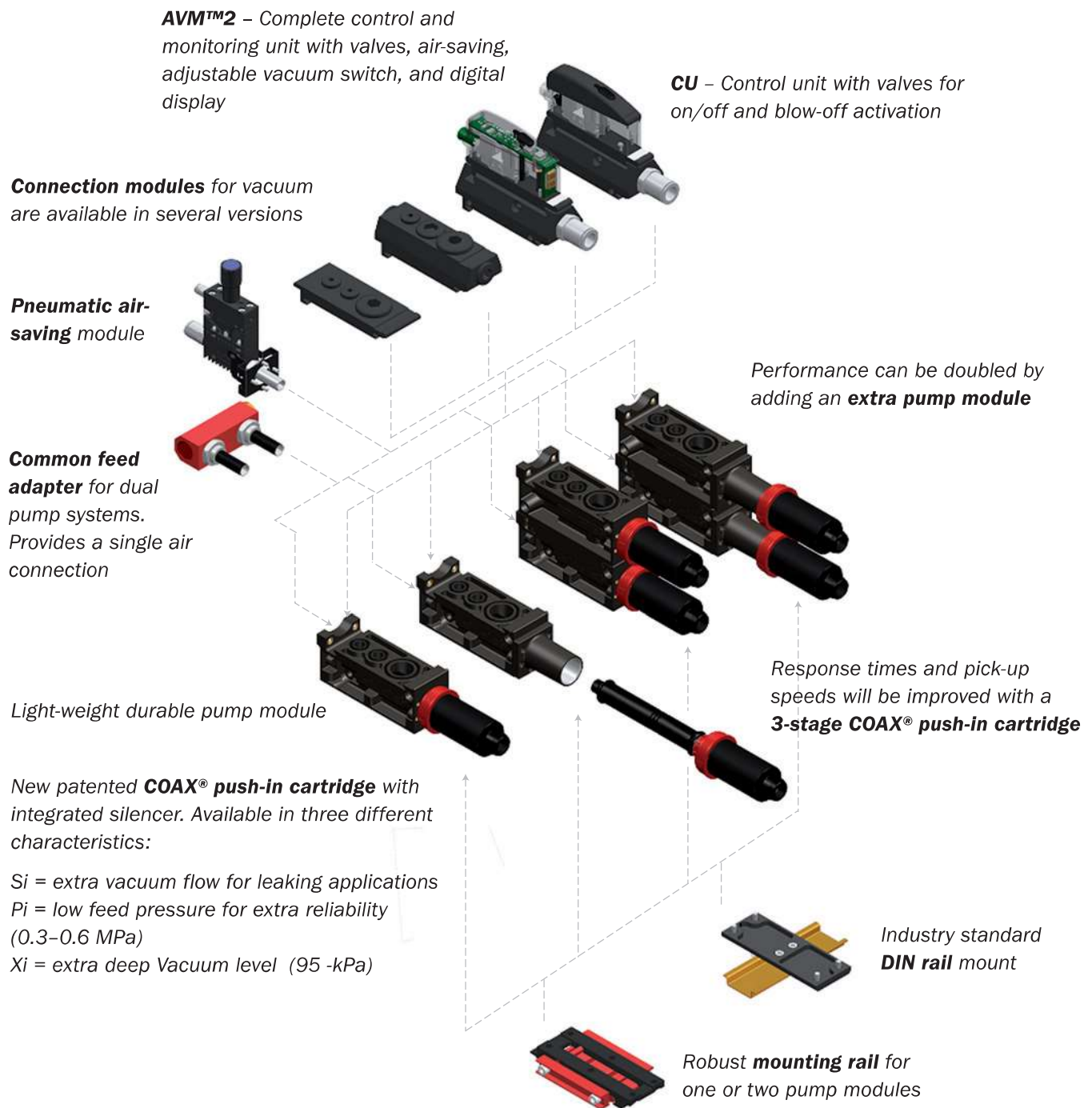

## P5010 CU



- ▶ P5010 multistage ejector with Pi, Si or Xi COAX® push-in cartridge(s).
- ▶ Integrated Control Unit (CU) with electric valves for vacuum on-off and blow-off control.
- ▶ Mechanical valve for blow-off flow adjustment.
- ▶ Enhanced blow-off power thanks to a directed blow-off pipe.
- ▶ Special M12 4-pin cable assembly with LED for status of valve signals.
- ▶ Slim, compact, configurable and modular design.

### TECHNICAL DATA

Description	Unit	Value
Feed pressure, max	MPa	0.7
Noise level *)	dBA	68–71
Temperature range	°C	0–50
Weight	g	430–720
Material		AL, CuZn, NBR, PA, SS, PE, PMMA
Voltage	VDC	24 (22–28)
Safety classification		IP65 [NEMA4]
Humidity	%RH	90
Current consumption, nominal	mA	60
Ripple, max.	V <sub>p</sub>	1 V <sub>rms</sub>
Flow, blow-off	NI/s	0–7.5
Function, on/off		NC

\*) At vacuum level 40 -kPa and at recommended feed pressure for respective push-in cartridge.

When using P5010 with two COAX® push-in cartridges and CU, there are flow restrictions down to 30 -kPa.

## ORDERING INFORMATION

1. Housing		P5010 code
Housing, connection Ø 10 mm		00
Housing, connection Ø 3/8"		01
2. COAX® push-in modules		P5010 code
b	COAX® push-in module Pi48-2X1	AI
a	COAX® push-in module Pi48-3X1	AJ
d	COAX® push-in module Pi48-2X1, non-return valve	AK
c	COAX® push-in module Pi48-3X1, non-return valve	AL
b	COAX® push-in module Pi48-2X2	AM
a	COAX® push-in module Pi48-3X2	AN
d	COAX® push-in module Pi48-2X2, non-return valve	AO
c	COAX® push-in module Pi48-3X2, non-return valve	AP
b	COAX® push-in module Si32-2X1	AA
a	COAX® push-in module Si32-3X1	AB
d	COAX® push-in module Si32-2X1, non-return valve	AC
c	COAX® push-in module Si32-3X1, non-return valve	AD
b	COAX® push-in module Si32-2X2	AE
a	COAX® push-in module Si32-3X2	AF
d	COAX® push-in module Si32-2X2, non-return valve	AG
c	COAX® push-in module Si32-3X2, non-return valve	AH
b	COAX® push-in module Xi40-2X1	AQ
a	COAX® push-in module Xi40-3X1	AR
d	COAX® push-in module Xi40-2X1, non-return valve	AS
c	COAX® push-in module Xi40-3X1, non-return valve	AT
b	COAX® push-in module Xi40-2X2	AU
a	COAX® push-in module Xi40-3X2	AV
d	COAX® push-in module Xi40-2X2, non-return valve	AW
c	COAX® push-in module Xi40-3X2, non-return valve	AX
3. Function		P5010 code
Function CU NC G threads		09
Function CU NC NPSF threads		10
Example		Ordering number
Housing, connection Ø 10 mm Pi48-2X1, function CU NC G threads		P5010 00 A1 09

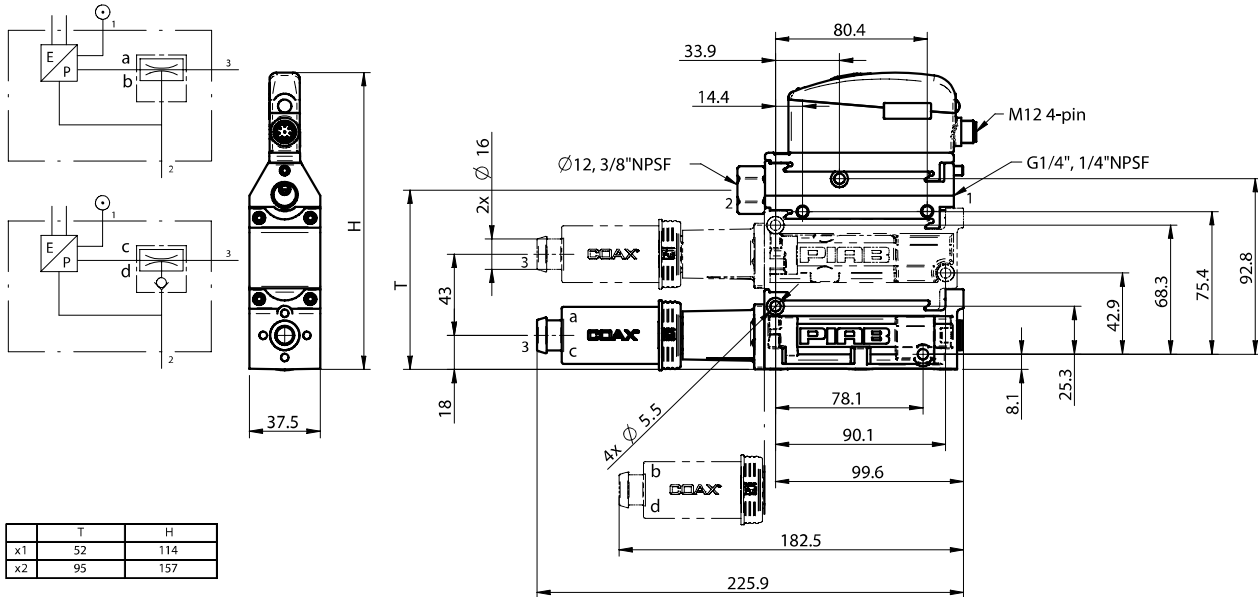

## ORDERING INFORMATION, ACCESSORIES

Description	Art. No.
Cable M12 4-pin female, LED indicator, PUR, L=5m	0118013