

Rosemount[™] 2410 Tank Hub



Handles communication between tank devices and the control room

- Save installation cost with the bus-powered intrinsically safe 2-wire Tankbus
- Calculate average temperature, observed density, and strapping table based volume
- Simplify start-up with tank device auto-configuration
- Many communication possibilities, including Modbus[®], IEC 62591 (*WirelessHART[®]*), and emulation of other vendors' protocols
- Two configurable alarm output relays
- Certified SIL 2 or SIL 3 (relay or analog output)

Rosemount 2410 Tank Hub for single or multiple tanks

Efficient communication between tanks and control room

Rosemount 2410 handles communication between the field devices and the control room. It also provides IEC 61508 certified SIL 2 and SIL 3 overfill prevention alarm outputs for the Rosemount Tank Gauging System. The device is available in three versions, for single tanks, multiple tanks, and functional safety/SIS applications (SIL 2 single tank).

Figure 1: Tank Gauging System Overview

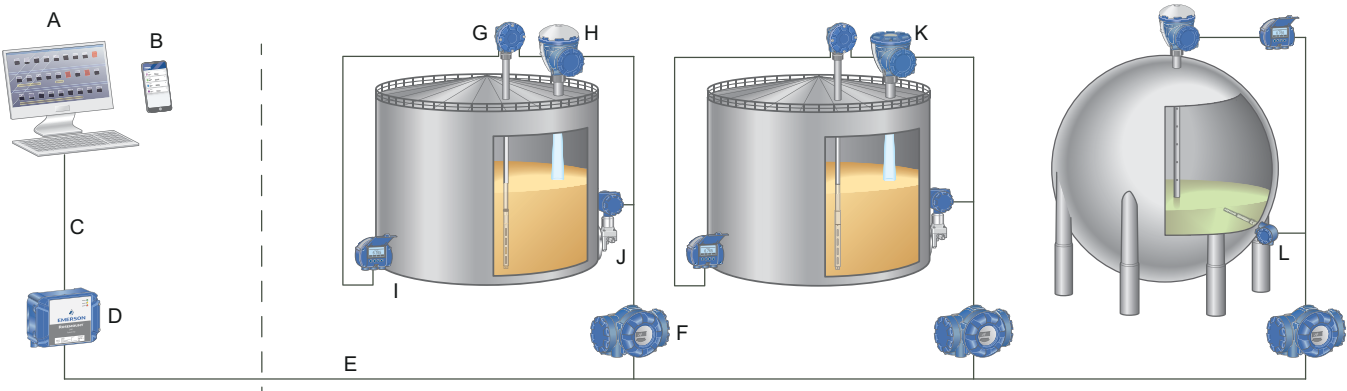

- A. Rosemount TankMaster Inventory Management
- B. Rosemount TankMaster Mobile Inventory Management
- C. Modbus® RTU/TCP
- D. Rosemount 2460 System Hub
- E. Tankbus
- F. Rosemount 2410 Tank Hub
- G. Rosemount 2240S Multi-input Temperature Transmitter with Rosemount 765 Multiple Spot Temperature and Water Level Sensor
- H. Rosemount 5900S Radar Level Gauge
- I. Rosemount 2230 Graphical Field Display
- J. Rosemount 3051S Pressure Transmitter
- K. Rosemount 5900C Radar Level Gauge
- L. Rosemount 3144P Temperature Transmitter with Rosemount 114C or 214C Single Point Temperature Sensor

Contents

| | |
|--|----|
| Rosemount 2410 Tank Hub for single or multiple tanks..... | 2 |
| Ordering information..... | 7 |
| Specifications..... | 21 |
| Specifications for Emerson Wireless 775 THUM Adapter Assembly..... | 36 |
| Product certifications..... | 38 |
| Dimensional drawings..... | 39 |

Tankbus communication

The Rosemount 2410 Tank Hub communicates with and powers the devices on one or several tanks via the Tankbus.

The Tankbus complies with Fieldbus Intrinsically Safe Concept (FISCO) FOUNDATION™ Fieldbus.

By using FISCO, there is no need to take entity parameters into consideration. It makes it easy to connect devices.

In addition, the available power from a FISCO power supply is higher compared to a conventional entity power supply. This enables the connection of more devices on the Tankbus.

Auto-configure tank devices

The Rosemount 2410 supports the auto-configuration of the Tankbus devices within the Rosemount Tank Gauging System. It acts as a FOUNDATION Fieldbus master on the Tankbus, which means it identifies and auto-addresses field devices in the network, manages communication, and supervises the status of all connected devices. It also includes extensive built-in diagnostics.

Data handling and calculation

Rosemount 2410 collects measurement values such as level, temperature, and pressure.

It calculates average temperature, observed density, and strapping table based volume.

Such data can be presented on the optional integrated back-lit display, a separate Rosemount 2230 Graphical Field Display, and can be sent to a host system.

Improve data security

All tank hubs have a software write-protection function.

In addition, the Rosemount 2410 with display option is equipped with a hardware write-protection switch.

Control room communication

Rosemount 2410 has slots for two independent communication boards (primary and secondary fieldbus) for TRL2 Modbus, RS485 Modbus, emulation, and wireless communication.

Power supply with built-in cable terminator

Rosemount 2410 supplies power to the units on the Tankbus.

It is equipped with an integrated FISCO-certified IS barrier, has power conditioner functionality, and built-in electronics for bus termination. A terminator at each end of the Tankbus ensures that the fieldbus network has proper signal levels.

All these features enable the easy setup of the Rosemount Tank Gauging System.

Analog input/output

The Rosemount 2410 Tank Hub can be ordered with:

- An analog input
- An analog output for connection to a host system
- The analog output is available as certified SIL 2 for overfill prevention or dry-run protection. Suitable for connection to an automatic overfill prevention system.

Emulate gauges from other vendors

Rosemount 2410 enables replacement of old mechanical/servo gauges with modern Rosemount devices.

When an old gauge from another vendor is replaced with a tank hub connected to a Rosemount field device, the tank hub will act just like the replaced gauge.

By using the other vendor's field and control room communication protocol together with modern Rosemount tank gauging devices, the legacy system can be modernized step-by-step. The legacy system can be upgraded while tanks are in operation, and the existing wiring can be re-used.

Figure 2: Emulation

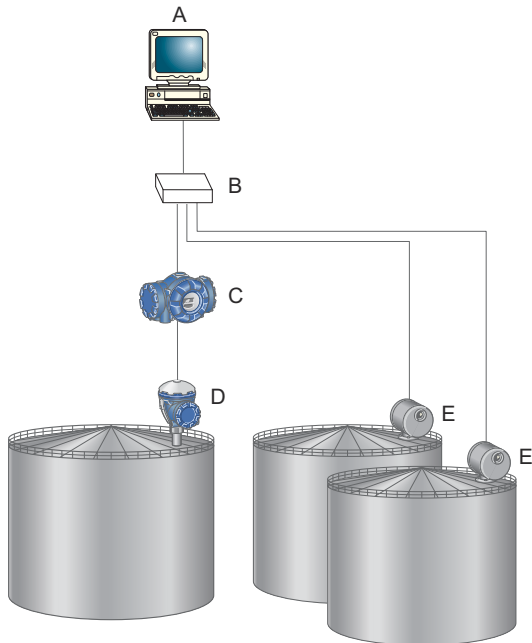

- A. Existing host system from other vendor
- B. Existing data polling unit
- C. Rosemount 2410 Tank Hub
- D. Rosemount 5900S Radar Level Gauge
- E. Gauges from other vendor in an existing system

Rosemount 2410 and Rosemount 5900S replacing a servo gauge in a system from another vendor. Rosemount devices are seamlessly integrated into the existing system.

Output relay functionality

Rosemount 2410 can be equipped with two solid-state relays that can be configured to be controlled by level, temperature, and water level. The output is normally connected to an external system for alarm indication or process control.

These relays are user-configurable for normally open or closed operation. They can be either certified SIL 2, and used for overfill prevention via an emergency shutdown system (ESD), or non-SIL.

A third separate relay dedicated for SIL 3 overfill functionality can also be included. This relay is activated both if the alarm level is reached and/or if a device malfunction occurs. It operates in a normally closed mode, and the output can be connected to an ESD system.

Rosemount 2410:SIS Tank Hub for SIS applications (SIL 2)

The Rosemount 2410:SIS Tank Hub (Tankbus: number of tanks option code F) is designed for functional safety/SIS applications (SIL 2 single tank):

- Supports one Rosemount 5900 SIL 2 safety level device for overfill or dry-run protection.
- Typically used in combination with Rosemount 2410 single tank hub for an independent SIL certified protection layer.

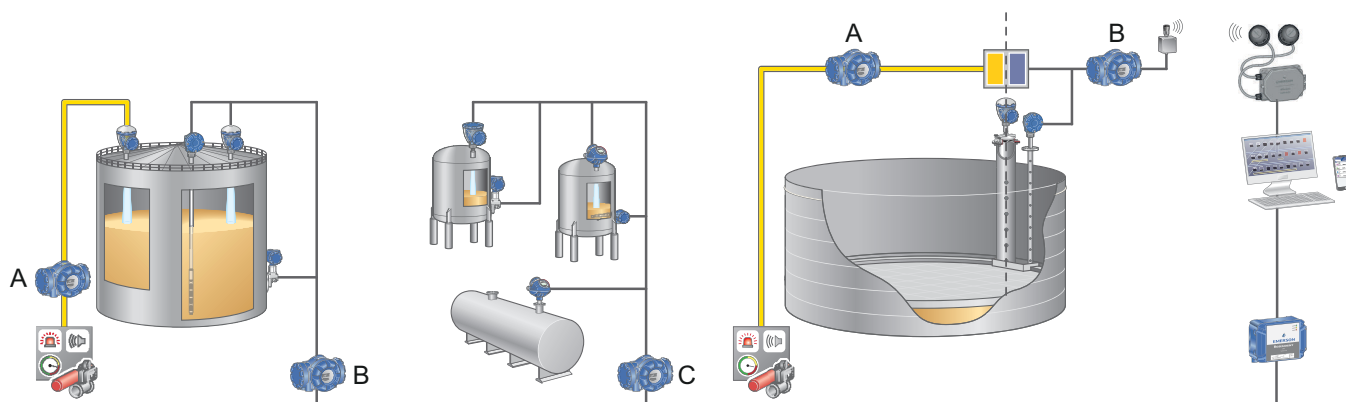

- A. Rosemount 2410:SIS Tank Hub
 B. Rosemount 2410 Tank Hub for single tanks
 C. Rosemount 2410 Tank Hub for multiple tanks

Wireless communication

The Emerson Wireless 775 THUM™ Adapter acts as a wireless data link between the tank hub and an Emerson Wireless Gateway in a *WirelessHART®* field network. Available tank data such as level, temperature, etc. are transmitted via the wireless THUM Adapter.

[Figure 3](#) shows the Rosemount 2410 Tank Hub connected to an Emerson Wireless 775 THUM Adapter assembly with integrated junction box.

Figure 3: Wireless Communication



Access information when you need it with asset tags

Newly shipped devices include a unique QR code asset tag that enables you to access serialized information directly from the device. With this capability, you can:

- Access device drawings, diagrams, technical documentation, and troubleshooting information in your MyEmerson account
- Improve mean time to repair and maintain efficiency
- Ensure confidence that you have located the correct device
- Eliminate the time-consuming process of locating and transcribing nameplates to view asset information

Ordering information

Specifications and options

Specification and selection of product materials, options, and/or components must be made by the purchaser of the equipment. See the Material selection section for more information.

Model codes

Model codes contain the details related to each product. Exact model codes will vary; an example of a typical model code is shown in [Figure 4](#).

Figure 4: Model Code Example

| | |
|-----------------------------|--------|
| 2410 SFR 03 2 1 PSE1 RA 1 P | WR3 ST |
| 1 | 2 |

- 1. Required model components (choices available on most)
- 2. Additional options (variety of features and functions that may be added to products)

Rosemount 2410 Tank Hub



The Rosemount 2410 handles data communication between field devices and the control room, and is available in two versions for single or multiple tanks. Control room communication options include Modbus®, IEC 62591 (*WirelessHART®* protocol) and emulation of other vendors' protocols. The tank hub also feeds power to Rosemount field devices on the FISCO compliant intrinsically safe Tankbus.

[VIEW PRODUCT >](#)

Required model components

Model

| Code | Description |
|------|-------------|
| 2410 | Tank Hub |

Tankbus: number of tanks

| Code | Description |
|------------------|---|
| S ⁽¹⁾ | Single tank |
| M ⁽²⁾ | Multiple tanks (up to ten level devices per tank hub) |

(1) Supports one Rosemount 5900S 2-in-1 gauge or up to two Rosemount 5900 standard gauges.

(2) Up to five Rosemount 5300, up to 10 Rosemount 5408 per tank hub.

Tankbus: power and communication

| Code | Description |
|------|--|
| F | Intrinsically safe FOUNDATION™ Fieldbus (IEC 61158) power supply |

Primary fieldbus

| Code | Description |
|------------------|---|
| R | TRL2 Modbus |
| 4 | RS485 Modbus |
| E | Enraf® Bi-phase Mark GPU |
| H ⁽¹⁾ | Whessoe WM 550/660 (digital current loop) |
| G ⁽¹⁾ | GPE 31422/31423 (digital current loop) |
| U ⁽¹⁾ | Sakura (MDP/V1) |
| T ⁽¹⁾ | Tokyo Keiso |
| B ⁽¹⁾ | Analog output 4-20 mA/HART®, passive (non-IS) |
| 7 ⁽¹⁾ | Analog input 4-20 mA/HART®, passive (non-IS) |

(1) Requires Secondary fieldbus code W.

Secondary fieldbus

| Code | Description |
|------------------|--------------------------|
| R ⁽¹⁾ | TRL2 Modbus |
| E ⁽¹⁾ | Enraf® Bi-phase Mark GPU |

| Code | Description |
|---------------------|--|
| W ⁽²⁾⁽³⁾ | WirelessHART® (IEC 62591) connectivity (IS) |
| L ⁽¹⁾ | L&J Tankway Slave 1500 XL/MCG 2000 |
| V ⁽¹⁾ | Varec® Mark/Space GT 1800/1900 |
| H ⁽¹⁾ | Whessoe WM 550/660 (digital current loop) |
| G ⁽¹⁾ | GPE 31422/31423 (digital current loop) |
| U ⁽¹⁾ | Sakura (MDP/V1) |
| T ⁽¹⁾ | Tokyo Keiso |
| C ⁽³⁾⁽⁴⁾ | Analog output 4-20 mA/HART, active (IS) |
| A ⁽³⁾⁽⁴⁾ | Analog output 4-20 mA/HART, active (non-IS) |
| D ⁽⁴⁾ | Analog output 4-20 mA/HART, passive (IS) |
| B ⁽⁴⁾ | Analog output 4-20 mA/HART, passive (non-IS) |
| 8 ⁽³⁾⁽⁴⁾ | Analog input 4-20 mA/HART, active (IS) |
| 6 ⁽³⁾⁽⁴⁾ | Analog input 4-20 mA/HART, active (non-IS) |
| 9 ⁽⁴⁾ | Analog input 4-20 mA/HART, passive (IS) |
| 7 ⁽⁴⁾ | Analog input 4-20 mA/HART, passive (non-IS) |
| 0 ⁽⁴⁾ | None |
| F ⁽⁴⁾ | None, ready for upgrade of secondary bus |

(1) Requires Primary fieldbus code R or 4.

(2) Requires a separate Emerson Wireless 775 THUM Adapter (not included, to be ordered as a separate item).

(3) Power-supply integrated. Maximum Tankbus current reduced to 200 mA.

(4) Requires Primary fieldbus code R, 4 or E.

Safety certification (SIS)

| Code | Description |
|------------------------|---|
| 3 ⁽¹⁾⁽²⁾ | Certified IEC 61508 SIL 3 (Using relay 1xSPST, solid-state. Certification is valid only when connected to a safety-certified Rosemount 5900 according to reference manual). |
| S ⁽²⁾⁽³⁾ | Certified IEC 61508 SIL 2 (using analog or relay output) |
| F ⁽²⁾⁽³⁾⁽⁴⁾ | None, ready for upgrade of safety certification (SIS) |
| 0 | None |

(1) Requires Secondary fieldbus code 0, or Secondary fieldbus code W, C, D, 8, 9, and Primary fieldbus code 4.

(2) Requires Number of tanks code S.

(3) Requires Relay output code 2 or 1, or Primary fieldbus Code B, or Secondary fieldbus code A, B, C or D for SIL 2 (Safety certification code S).

(4) Requires Secondary fieldbus code 0 or F for SIL3 (Safety certification code 3).

Relay output

| Code | Description |
|------|---|
| 2 | 2xSPST, solid-state |
| 1 | 1xSPST, solid-state |
| F | None, ready for upgrade of relay output |
| 0 | None |

Integral display

| Code | Description |
|------|-------------|
| 1 | LCD |
| 0 | None |

Power supply

| Code | Description |
|------|---|
| P | Extended input range: 48-240 Vac at 50/60 Hz, and 24-48 Vdc |

Firmware

| Code | Description |
|------|-------------|
| S | Standard |

Hazardous location certification

| Code | Description |
|-------------------|--|
| E1 | ATEX Flameproof |
| E7 | IECEx Flameproof |
| E5 | FM-US Explosion-proof |
| E6 | FM-Canada Explosion-proof |
| E4 | Japan Flameproof |
| E2 | INMETRO Flameproof (Brazil) |
| E3 | China Flameproof |
| EP ⁽¹⁾ | KC Flameproof (South Korea) |
| EW | CCOE/PESO Flameproof Certification (India) |
| EM | Technical Regulations Customs Union (EAC) Flameproof |
| NA | No hazardous location certification |

(1) Requires Custody transfer type approval code R or 0.

Custody transfer type approval

Requires a Rosemount 5900S Radar Level Gauge with corresponding Custody transfer type approval.

| Code | Description |
|------------------|---|
| R | OIML R85 E 2008 performance certification |
| A | CMI (Czech Republic W&M approval) |
| B | NMI (Australia) |
| C | PTB (German W&M approval) |
| E | TJA (Estonia W&M approval) |
| I | Ministero (Italy) |
| K ⁽¹⁾ | GOST (Kazakhstan) |
| L | LNE (France) |
| M | BMS (Belgium W&M) |
| N | NMi (the Netherlands W&M approval) |
| O | ONML (Algeria) |
| Q | IPQ (Portugal) |
| T | ANM (Tunisia) |
| V | BEV (Austria) |
| W | METAS (Switzerland W&M approval) |
| 0 | None |

(1) Requires Hazardous location certification code E1.

Housing

| Code | Description |
|------|---|
| A | Aluminum (polyurethane-covered), IP 66/67 |

Cable/conduit connections

| Code | Description | Includes |
|------------------|---|---|
| 1 | ½-14 NPT and ¾-14 NPT, female thread | <ul style="list-style-type: none"> 1 pcs ½-14 NPT plug 2 pcs ¾-14 NPT plugs |
| 2 | M20 x 1.5 and M25 x 1.5 adapters, female thread | <ul style="list-style-type: none"> 1 pcs ½-14 NPT plug 2 pcs ¾-14 NPT plugs 4 pcs ½-14 NPT->M20 x 1.5 adapters 2 pcs ¾-14 NPT->M25 x 1.5 adapters |
| G ⁽¹⁾ | Metal cable glands (½-14 and ¾-14 NPT) | <ul style="list-style-type: none"> 1 pcs ½-14 NPT plug 2 pcs ¾-14 NPT plugs 4 pcs ½-14 NPT cable glands 2 pcs ¾-14 NPT cable glands |
| E | eurofast® male connector | <ul style="list-style-type: none"> 1 pcs male connector |
| M | minifast® male connector | <ul style="list-style-type: none"> 1 pcs ½-14 NPT plug 2 pcs ¾-14 NPT plugs |

(1) Minimum temperature -20 °C (-4 °F). ATEX/IECEx Ex e approved.

Mechanical installation

| Code | Description |
|------|---|
| W | Mounting kit for wall installation |
| P | Mounting kit for both wall and pipe installation (1-2-in. vertical or horizontal pipes) |

Additional options**Safety certificate**

Requires Safety certification (SIS) code S or 3.

| Code | Description |
|------|--------------------------------------|
| QT | IEC 61508 certificate and FMEDA data |

Conformance certificate

| Code | Description |
|------|--|
| Q1 | Printed copy of certificate of conformance |

Hazardous location certificate

| Code | Description |
|------|--|
| Q7 | Printed copy of hazardous location certificate |

Overfill protection approval

Requires Safety certification (SIS) code 3, or Relay output code 1 or 2.

| Code | Description |
|------|---|
| U1 | TÜV/DIBt WHG approval for overfill protection |
| U2 | SVTI approval for overfill protection (Switzerland) |

Tag plate

| Code | Description |
|------|--|
| ST | Engraved SST tag plate (tag shall be submitted with order) |

Extended product warranty

Rosemount extended warranties have a limited warranty of three or five years from date of shipment.

| Code | Description |
|------|-------------------------|
| WR3 | 3-year limited warranty |
| WR5 | 5-year limited warranty |

Rosemount 2410:SIS Tank Hub



The Rosemount 2410:SIS Tank Hub (Tankbus: number of tanks option code F) is designed for functional safety/SIS applications (SIL 2 single tank).

[VIEW PRODUCT >](#)

Required model components

Model

| Code | Description |
|------|-------------|
| 2410 | Tank Hub |

Tankbus: number of tanks

| Code | Description |
|------------------|--|
| F ⁽¹⁾ | Functional safety / SIS applications (SIL 2 single tank) |

(1) Supports one Safety Certified Rosemount 5900 level gauge.

Tankbus: power and communication

| Code | Description |
|------|--|
| F | Intrinsically safe FOUNDATION™ Fieldbus (IEC 61158) power supply |

Primary fieldbus

| Code | Description |
|------------------|---|
| R | TRL2 Modbus |
| 4 | RS485 Modbus |
| B ⁽¹⁾ | Analog output 4-20 mA/HART®, passive (non-IS) |

(1) Requires Secondary fieldbus code W.

Secondary fieldbus

| Code | Description |
|---------------------|--|
| R ⁽¹⁾ | TRL2 Modbus |
| W ⁽²⁾⁽³⁾ | WirelessHART® (IEC 62591) connectivity (IS) |
| C ⁽¹⁾⁽³⁾ | Analog output 4-20 mA/HART, active (IS) |
| A ⁽¹⁾⁽³⁾ | Analog output 4-20 mA/HART, active (non-IS) |
| D ⁽¹⁾ | Analog output 4-20 mA/HART, passive (IS) |
| B ⁽¹⁾ | Analog output 4-20 mA/HART, passive (non-IS) |
| Q ⁽¹⁾ | None |
| F ⁽¹⁾ | None, ready for upgrade of secondary bus |

(1) Requires Primary fieldbus code R or 4.

(2) Requires a separate Emerson Wireless 775 THUM Adapter (not included, to be ordered as a separate item).

(3) *Power-supply integrated. Maximum Tankbus current reduced to 200 mA.*

Safety certification (SIS)

| Code | Description |
|------------------|--|
| S ⁽¹⁾ | Certified IEC 61508 SIL 2 (using analog or relay output) |

(1) *Requires Relay output code 2 or 1, or Primary fieldbus Code B, or Secondary fieldbus code A, B, C or D for SIL 2 (Safety certification code S).*

Relay output

| Code | Description |
|------|---|
| 2 | 2xSPST, solid-state |
| 1 | 1xSPST, solid-state |
| F | None, ready for upgrade of relay output |
| 0 | None |

Integral display

| Code | Description |
|------|-------------|
| 1 | LCD |
| 0 | None |

Power supply

| Code | Description |
|------|---|
| P | Extended input range: 48-240 Vac at 50/60 Hz, and 24-48 Vdc |

Firmware

| Code | Description |
|------|-------------|
| S | Standard |

Hazardous location certification

| Code | Description |
|-------------------|--|
| E1 | ATEX Flameproof |
| E7 | IECEx Flameproof |
| E5 | FM-US Explosion-proof |
| E6 | FM-Canada Explosion-proof |
| E4 | Japan Flameproof |
| E2 | INMETRO Flameproof (Brazil) |
| E3 | China Flameproof |
| EP ⁽¹⁾ | KC Flameproof (South Korea) |
| EW | CCOE/PESO Flameproof Certification (India) |

| Code | Description |
|------|--|
| EM | Technical Regulations Customs Union (EAC) Flameproof |
| NA | No hazardous location certification |

(1) Requires Custody transfer type approval code 0.

Custody transfer type approval

Requires a Rosemount 5900S Radar Level Gauge with corresponding Custody transfer type approval.

| Code | Description |
|------|-------------|
| 0 | None |

Housing

| Code | Description |
|------|---|
| A | Aluminum (polyurethane-covered), IP 66/67 |

Cable/conduit connections

| Code | Description | Includes |
|------------------|---|---|
| 1 | ½-14 NPT and ¾-14 NPT, female thread | <ul style="list-style-type: none"> 1 pcs ½-14 NPT plug 2 pcs ¾-14 NPT plugs |
| 2 | M20 x 1.5 and M25 x 1.5 adapters, female thread | <ul style="list-style-type: none"> 1 pcs ½-14 NPT plug 2 pcs ¾-14 NPT plugs 4 pcs ½-14 NPT->M20 x 1.5 adapters 2 pcs ¾-14 NPT->M25 x 1.5 adapters |
| G ⁽¹⁾ | Metal cable glands (½-14 and ¾-14 NPT) | <ul style="list-style-type: none"> 1 pcs ½-14 NPT plug 2 pcs ¾-14 NPT plugs 4 pcs ½-14 NPT cable glands 2 pcs ¾-14 NPT cable glands |
| E | eurofast® male connector | <ul style="list-style-type: none"> 1 pcs male connector |
| M | minifast® male connector | <ul style="list-style-type: none"> 1 pcs ½-14 NPT plug 2 pcs ¾-14 NPT plugs |

(1) Minimum temperature -20 °C (-4 °F). ATEX/IECEx Ex e approved.

Mechanical installation

| Code | Description |
|------|---|
| W | Mounting kit for wall installation |
| P | Mounting kit for both wall and pipe installation (1-2-in. vertical or horizontal pipes) |

Additional options

Safety certificate

Requires Safety certification (SIS) code S.

| Code | Description |
|------|--------------------------------------|
| QT | IEC 61508 certificate and FMEDA data |

Conformance certificate

| Code | Description |
|------|--|
| Q1 | Printed copy of certificate of conformance |

Hazardous location certificate

| Code | Description |
|------|--|
| Q7 | Printed copy of hazardous location certificate |

Overfill protection approval

Requires Relay output code 1 or 2.

| Code | Description |
|------|---|
| U1 | TÜV/DIBt WHG approval for overfill protection |
| U2 | SVTI approval for overfill protection (Switzerland) |

Tag plate

| Code | Description |
|------|--|
| ST | Engraved SST tag plate (tag shall be submitted with order) |

Extended product warranty

Rosemount extended warranties have a limited warranty of three or five years from date of shipment.

| Code | Description |
|------|-------------------------|
| WR3 | 3-year limited warranty |
| WR5 | 5-year limited warranty |

Emerson Wireless 775 THUM Adapter Assembly



- Add wireless access to any measurement point
- Wireless output protected by industry leading security
- Gain access to additional information such as diagnostics or multivariable data

[VIEW PRODUCT >](#)

Required model components

Model

| Code | Description | |
|------|---------------------------|--|
| 775 | Wireless 775 THUM Adapter | |

Output

| Code | Description | |
|------|-------------|--|
| X | Wireless | |

Housing

| Code | Description | |
|------|-----------------------|---|
| D | Aluminum | ★ |
| E | Stainless steel (SST) | |

Mounting connection

| Code | Description | |
|------|---------------------|---|
| 1 | ½-14 NPT | ★ |
| 2 | M20 conduit adapter | ★ |

Input protocol

| Code | Description | |
|------|-------------|--|
| 1 | HART® data | |

Certification

| Code | Description | |
|------|---|---|
| NA | No approval | ★ |
| I1 | ATEX Intrinsic Safety | ★ |
| I2 | Brazil (INMETRO) Intrinsic Safety | ★ |
| I4 | Japan (CML) Intrinsically Safe | ★ |
| I5 | USA Intrinsically Safe, Non-incendive | ★ |
| I6 | Canada Intrinsically Safe | ★ |
| I7 | IECEX Intrinsically Safe | ★ |
| N1 | ATEX Type n | ★ |
| N2 | Brazil (INMETRO) Type n | ★ |
| N7 | IECEX Type n | ★ |
| IP | Korea (KOSHA) Intrinsic Safety | ★ |
| IM | Technical Regulations Customs Union (EAC) Intrinsic Safety | ★ |
| NM | Technical Regulations Customs Union (EAC) Type n | |
| KM | Technical Regulations Customs Union (EAC) Intrinsic Safety Type n | |

Wireless update rate, operating frequency, and protocol

| Code | Description | |
|------|--|---|
| WA3 | User-configurable update rate, 2.4 GHz, IEC 62591 (<i>WirelessHART®</i>) | ★ |

Omni-directional antenna and SmartPower™ solutions

| Code | Description | |
|------|--|---|
| WK9 | Long range, integral antenna, power scavenging | ★ |

Assemble to options

| Code | Description |
|------------------|---------------|
| T ⁽¹⁾ | 2410 Tank Hub |

(1) Factory mounted 220 Ω 4W loop resistor.

Cable/conduit connection

| Code | Description |
|------------------|--------------------------------|
| 0 | None (M20 x 1.5 female thread) |
| J ⁽¹⁾ | Metal cable gland |
| F | ½ NPT adapter (female thread) |

(1) Minimum temperature -20 °C (-4 °F) ATEX/IECEX.

Additional options

Engraved tag

| Code | Description |
|-------------------|-----------------------|
| ST ⁽¹⁾ | Engraved ST tag plate |

(1) Maximum 15 characters. Place tag information in order.

Specifications

General specifications

Material selection

Emerson provides a variety of Rosemount products with various product options and configurations, including materials of construction that can be expected to perform well in a wide range of applications.

The product information presented is intended as a guide for the purchaser to make an appropriate selection for the application. It is the purchaser's sole responsibility to make a careful analysis of all process parameters (such as all chemical components, temperature, pressure, flow rate, abrasives, contaminants, etc.), when specifying product, materials, options, and components for the particular application. Emerson is not in a position to evaluate or guarantee the compatibility of the process fluid or other process parameters with the product, options, configuration, or materials of construction selected.

Single tank version

For a Rosemount 5900 system configuration when used in BPCS and safety instrumented systems:

- Supports one Rosemount 5900S 2-in-1 gauge or up to two Rosemount 5900 standard gauges
- Total Observed Volume (TOV) and API corrected Net Standard Volume (NSV) calculation with 100-point strapping table

Multiple tank version

For a Rosemount 5300/5408/5900 system configuration:

- The software supports 16 field devices and 10 tanks per tank hub
- Maximum five type Rosemount 5300 gauges per tank hub

The actual number of tanks/instruments a tank hub supports depends on the configuration, which types of units are connected and how many:

- Hybrid calculations (mass and density) for up to three tanks
- Total Observed Volume (TOV) and API corrected Net Standard Volume (NSV) calculation with 100-point strapping table for one tank

For more information, see [Table 5](#).

Functional safety/SIS applications (SIL 2 single tank) version

The Rosemount 2410:SIS Tank Hub is included in a Rosemount 5900 system configuration when used in safety instrumented systems:

- Supports one Rosemount 5900 SIL 2 safety level device for overfill or dry-run protection
- SIL 2 certified outputs (Relays and Analog Output)
- Data is limited to Tank Position 1: Level, Ullage, Level Rate, Signal Strength, Tank Height, Vapor Temp (Temp 1), and Vapor Pressure
- Typically used in combination with Rosemount 2410 single tank hub for an independent SIL certified protection layer

Supported Rosemount field devices

Level

Rosemount 5900 Radar Level Gauge⁽¹⁾, Rosemount 5408 Level Transmitter, Rosemount 5300 Level Transmitter, and Rosemount 5400 Level Transmitter

Temperature

Rosemount 2240S Multi-input Temperature Transmitter, Rosemount 3144P Temperature Transmitter, Rosemount 848T Temperature Transmitter, and Rosemount 644 Temperature Transmitter

Display

Rosemount 2230 Graphical Field Display and Rosemount 752 FOUNDATION™ Fieldbus Remote Indicator

Pressure

Rosemount 3051 Pressure Transmitter, Rosemount 2051 Pressure Transmitter, Rosemount 3151 Pressure Transmitter, and Rosemount 3051SMV MultiVariable Mass Flow Transmitter

Logic input and output

Rosemount 848L Logic Transmitter with FOUNDATION Fieldbus

Density

Micro Motion™ FDM Fork Density Meter

Supported field devices from other vendors

Temperature

Foxboro® RTT15-F Temperature Transmitter, PR electronics 6350 FOUNDATION™ Fieldbus Transmitter, PR electronics 5350 FOUNDATION Fieldbus Transmitter, Siemens SITRANS TH400, and WIKA T53 Fieldbus Temperature Transmitter

Pressure

Honeywell® SmartLine ST700 Pressure Transmitter, Honeywell SmartLine ST800 Pressure Transmitter, Yokogawa® EJA Series Differential Pressure Transmitter, and Yokogawa EJX430A Gauge Pressure Transmitter

Start-up time

Less than 30 s

(1) One Rosemount 5900S with a 2-in-1 solution or maximum two standard Rosemount 5900 gauges installed on separate tanks can be connected to one tank hub.

Communication/display/configuration specifications

Tankbus

The intrinsically safe side of the Rosemount 2410 connects to the Tankbus, which communicates with the field devices on the tank using FOUNDATION™ Fieldbus.

Fieldbus

Rosemount 2410 communicates with a Rosemount 2460 System Hub, Rosemount TankMaster, or a host via the supported communication protocols for the primary and secondary fieldbus.

| | |
|----------------------------|---|
| Primary fieldbus: | TRL2 Modbus, RS485 Modbus, Analog output/input 4-20 mA/HART, Enraf® Bi-phase Mark GPU, Whessoe WM 550/660 (digital current loop), GPE 31422/31423 (digital current loop), Sakura MDP/V1, or Tokyo Keiso. |
| Secondary fieldbus: | TRL2 Modbus, Analog output/input 4-20 mA/HART, <i>WirelessHART</i> ®, Enraf Bi-phase Mark GPU, L&J Tankway 1500 XL/MCG 2000, Varec® Mark/Space GT 1800/1900, Whessoe WM 550/660 (digital current loop), GPE 31422/31423 (digital current loop), Sakura MDP/V1 or Tokyo Keiso. |

For combination guidance, see [Table 1](#), [Table 2](#), and [Table 3](#).

Relay outputs

| | |
|--|---|
| SIL 3 relay output: | One certified SIL 3 relay is available for overfill prevention. This non-intrinsically safe solid state relay is closed/energized during normal operation. Maximum voltage and current: 260 Vac/Vdc, 80 mA single pole |
| Relay outputs (SIL 2 or non-SIL): | Maximum two relays, controlled by 10 independent virtual relay functions, which can be configured for different tanks and process variables. The two non-intrinsically safe solid state relays are user configurable for normally energized or de-energized operation. Maximum voltage and current: 350 Vac/Vdc, 80 mA single pole |

For combination guidance, see [Table 1](#), [Table 2](#), and [Table 3](#).

Analog input/output

The tank hub supports analog output and input 4-20 mA/HART, active or passive, IS or non-IS. The analog output is available as certified SIL 2.

Analog input

Maximum number of input channels: 1

Input Current range: 0-23 mA

Configurable Min and Max alarm limits.

For IS parameters, see [Product Certifications](#).

External Supply Voltage:

- Passive Non-IS: 7.2 - 35 Vdc
- Passive IS: 8.7 - 30 Vdc

Maximum Output Voltage (open loop):

- Active Non-IS: 24 Vdc
- Active IS: 23 Vdc

HART master:

- Maximum 5 HART Slave Devices (Passive)
- Maximum 3 HART Slave Devices (Active)

Figure 5: Loop Resistance: Passive Non-IS Analog Input

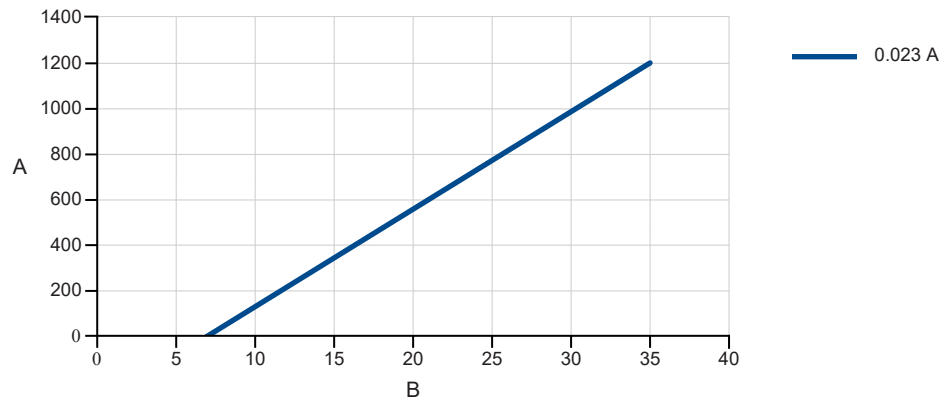

A. Loop resistance [Ω]

B. External power supply voltage [V]

Max Loop Resistance⁽²⁾ @ 23 mA = 43.4 * (External Power Supply Voltage - 7.2) [Ω]

Figure 6: Loop Resistance: Passive IS Analog Input

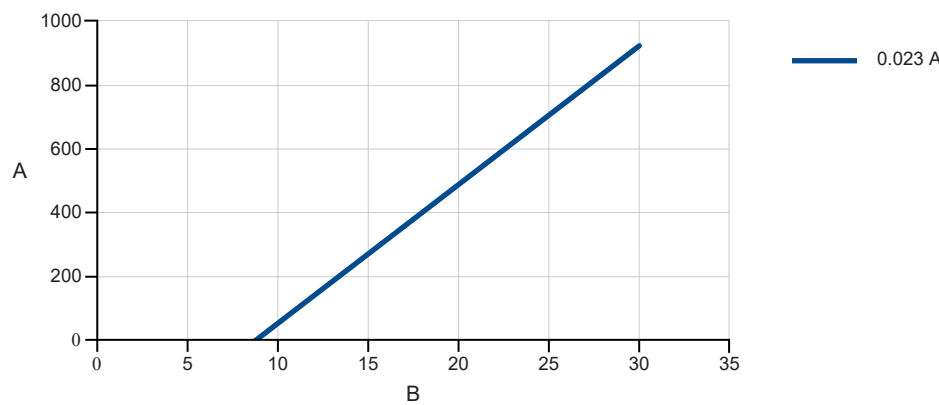

A. Loop resistance [Ω]

B. External power supply voltage [V]

Max Loop Resistance⁽²⁾ @ 23 mA = 43.4 * (External Power Supply Voltage - 8.7) [Ω]

(2) Any sense resistance must be subtracted from calculated max loop resistance to receive the maximum cable resistance.

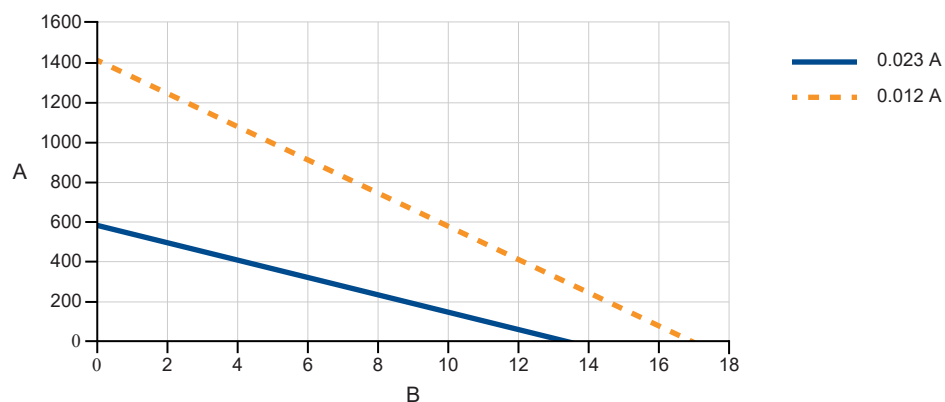
Figure 7: Loop Resistance: Active Non-IS Analog Input

A. Loop resistance [Ω]

B. Lift-off voltage [V]

Max Loop Resistance⁽²⁾ = (20.9 – Lift-off Voltage)/Max Loop Current – 330 [Ω]

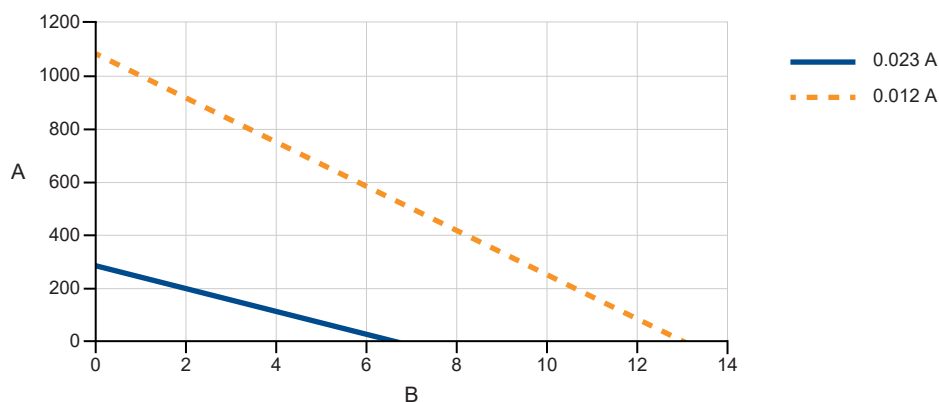
Figure 8: Loop Resistance: Active IS Analog Input

A. Loop resistance [Ω]

B. Lift-off voltage [V]

Max Loop Resistance⁽²⁾ = (20.1 – Lift-off Voltage)/Max Loop Current – 590 [Ω]

Analog output

Maximum number of output channels: 1

Output range: 3.5-23 mA

Software configurable High and Low Alarm Limits.

Separate software configurable alarms for process and hardware failures.

Low voltage and invalid loop current detection.

SIL 2 capable.

External Supply Voltage:

- Passive Non-IS: 8.0 - 35 Vdc
- Passive IS: 9.4 – 30 Vdc

Maximum Output Voltage (open loop):

- Active Non-IS: 24 Vdc
- Active IS: 23 Vdc

Figure 9: Loop Resistance: Passive Non-IS Analog Output

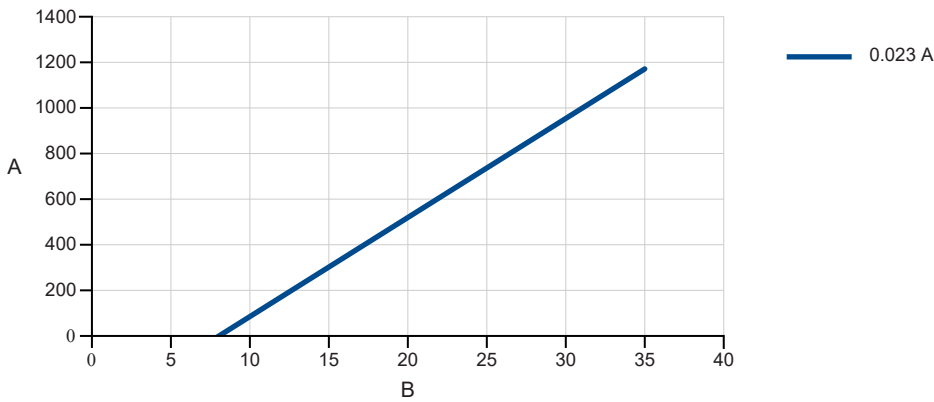

- A. Loop resistance [Ω]
- B. External power supply voltage [V]

Max Loop Resistance⁽²⁾ @ 23 mA = $43.4 * (\text{External Power Supply Voltage} - 8)$ [Ω]

Figure 10: Loop Resistance: Passive IS Analog Output

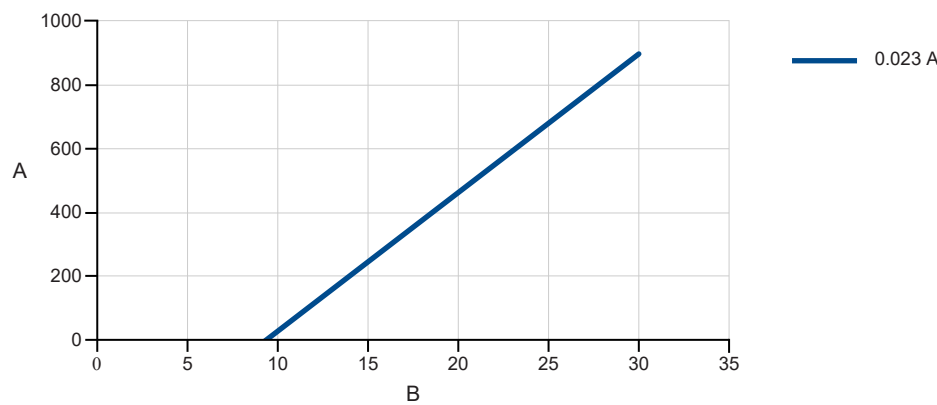

- A. Loop resistance [Ω]
- B. External power supply voltage [V]

Max Loop Resistance⁽²⁾ @ 23 mA = $43.4 * (\text{External Power Supply Voltage} - 9.4)$ [Ω]

Figure 11: Loop Resistance: Active Non-IS Analog Output

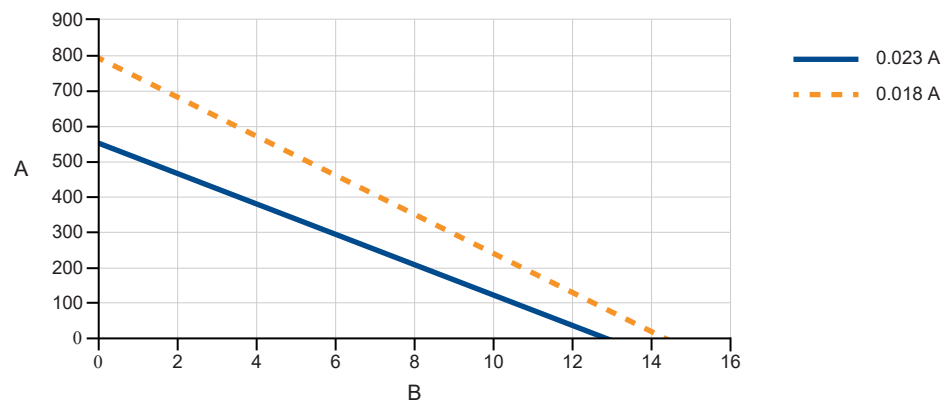

- A. Loop resistance [Ω]
- B. Lift-off voltage [V]

Max Loop Resistance⁽²⁾ = (20.3 – Lift-off Voltage)/Max Loop Current – 330 [Ω]

Figure 12: Loop Resistance: Active IS Analog Output

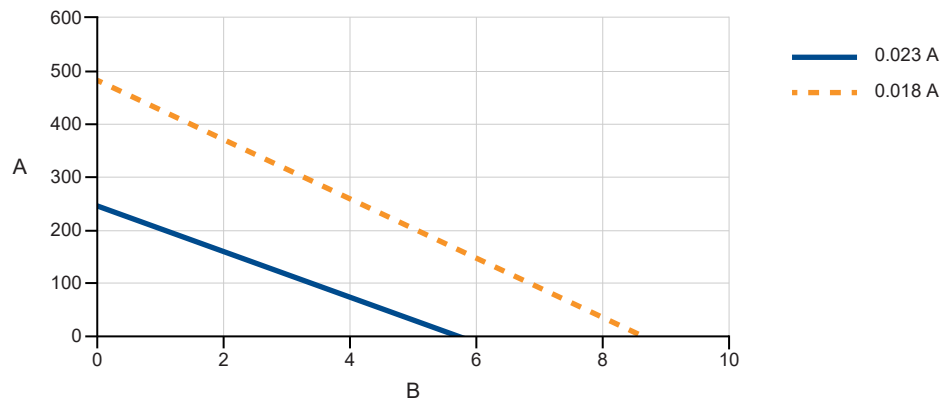

- A. Loop resistance [Ω]
- B. Lift-off voltage [V]

Max Loop Resistance⁽²⁾ = (19.5 – Lift-off Voltage)/Max Loop Current – 600 [Ω]

Fieldbus combinations

Table 1: Fieldbus Combination Matrix (Non-SIL)

| | | Primary Fieldbus options | | | | | |
|---|------|--------------------------|-------|-------|---|------------------------------------|-----------------------------------|
| | | TRL2 | RS485 | Enraf | Whessoe, GPE, Sakura, Tokyo Keiso | Analog out passive (non- IS) | Analog In passive (non- IS) |
| Secondary Fieldbus options | Code | R | 4 | E | H, G, U, T | B | 7 |
| TRL2 | R | Yes | Yes | No | No | No | No |
| Enraf | E | Yes | Yes | No | No | No | No |
| WirelessHART® | W | Yes | Yes | Yes | Yes | Yes | Yes |
| L&J Tankway 1500 XL/MCG 2000 | L | Yes | Yes | No | No | No | No |
| Varec Mark/Space GT 1800/1900 | V | Yes | Yes | No | No | No | No |
| Whessoe WM 550/660 (digital current loop) | H | Yes | Yes | No | No | No | No |
| GPE 31422/31423 (digital current loop) | G | Yes | Yes | No | No | No | No |
| Sakura MDP/V1 | U | Yes | Yes | No | No | No | No |
| Tokyo Keiso | T | Yes | Yes | No | No | No | No |
| Analog out active (IS) | C | Yes | Yes | Yes | No | No | No |
| Analog out active (non-IS) | A | Yes | Yes | Yes | No | No | No |
| Analog out passive (IS) | D | Yes | Yes | Yes | No | No | No |
| Analog out passive (non-IS) | B | Yes | Yes | Yes | No | No | No |
| Analog in active (IS) | 8 | Yes | Yes | Yes | No | No | No |
| Analog in active (non-IS) | 6 | Yes | Yes | Yes | No | No | No |
| Analog in passive (IS) | 9 | Yes | Yes | Yes | No | No | No |
| Analog in passive (non-IS) | 7 | Yes | Yes | Yes | No | No | No |
| None | 0 | Yes | Yes | Yes | No | No | No |
| Ready for upgrade | F | Yes | Yes | Yes | No | No | No |

Yes = Primary Fieldbus and Secondary Fieldbus can be combined

No = Combination not possible

Table 2: Fieldbus Combination Matrix (SIL)

| | | Primary Fieldbus options | | | | | |
|---|------|--------------------------------|--------------------------------|--------------------------------|-----------------------------------|------------------------------|----------------------------|
| | | TRL2 | RS485 | Enraf | Whessoe, GPE, Sakura, Tokyo Keiso | Analog out passive (non-IS) | Analog In passive (non-IS) |
| Secondary Fieldbus options | Code | R | 4 | E | H, G, U, T | B | 7 |
| TRL2 | R | SIL 2 (relay) | SIL 2 (relay) | No | No | No | No |
| Enraf | E | SIL 2 (relay) | SIL 2 (relay) | No | No | No | No |
| WirelessHART | W | SIL 2 (relay) | SIL 2 (relay) or SIL 3 (relay) | SIL 2 (relay) | SIL 2 (relay) | SIL 2 (4-20 mA and/or relay) | SIL 2 (relay) |
| L&J Tankway 1500 XL/MCG 2000 | L | SIL 2 (relay) | SIL 2 (relay) | No | No | No | No |
| Varec Mark/Space GT 1800/1900 | V | SIL 2 (relay) | SIL 2 (relay) | No | No | No | No |
| Whessoe WM 550/660 (digital current loop) | H | SIL 2 (relay) | SIL 2 (relay) | No | No | No | No |
| GPE 31422/31423 (digital current loop) | G | SIL 2 (relay) | SIL 2 (relay) | No | No | No | No |
| Sakura MDP/V1 | U | SIL 2 (relay) | SIL 2 (relay) | No | No | No | No |
| Tokyo Keiso | T | SIL 2 (relay) | SIL 2 (relay) | No | No | No | No |
| Analog out active (IS) | C | SIL 2 (4-20 mA and/or relay) | SIL 2 (relay) or SIL 3 (relay) | SIL 2 (4-20 mA and/or relay) | No | No | No |
| Analog out active (non-IS) | A | SIL 2 (4-20 mA and/or relay) | SIL 2 (4-20 mA and/or relay) | SIL 2 (4-20 mA and/or relay) | No | No | No |
| Analog out passive (IS) | D | SIL 2 (4-20 mA and/or relay) | SIL 2 (relay) or SIL 3 (relay) | SIL 2 (4-20 mA and/or relay) | No | No | No |
| Analog out passive (non-IS) | B | SIL 2 (4-20 mA and/or relay) | SIL 2 (4-20 mA and/or relay) | SIL 2 (4-20 mA and/or relay) | No | No | No |
| Analog in active (IS) | 8 | SIL 2 (relay) | SIL 2 (relay) or SIL 3 (relay) | SIL 2 (relay) | No | No | No |
| Analog in active (non-IS) | 6 | SIL 2 (relay) | SIL 2 (relay) | SIL 2 (relay) | No | No | No |
| Analog in passive (IS) | 9 | SIL 2 (relay) | SIL 2 (relay) or SIL 3 (relay) | SIL 2 (relay) | No | No | No |
| Analog in passive (non-IS) | 7 | SIL 2 (relay) | SIL 2 (relay) | SIL 2 (relay) | No | No | No |
| None | 0 | SIL 2 (relay) or SIL 3 (relay) | SIL 2 (relay) or SIL 3 (relay) | SIL 2 (relay) or SIL 3 (relay) | No | No | No |
| Ready for upgrade | F | SIL 2 (4-20 mA and/or relay) | SIL 2 (4-20 mA and/or relay) | SIL 2 (4-20 mA and/or relay) | No | No | No |

SIL = Primary Fieldbus and Secondary Fieldbus can be combined with SIL

No = Combination not possible

Table 3: Fieldbus Combination Matrix (Rosemount 2410:SIS)

| | | Primary Fieldbus options | | |
|-----------------------------|------|------------------------------|--------------------------------|------------------------------|
| | | TRL2 | RS485 | Analog out passive (non-IS) |
| Secondary Fieldbus options | Code | R | 4 | B |
| TRL2 | R | SIL 2 (relay) | SIL 2 (relay) | No |
| WirelessHART | W | SIL 2 (relay) | SIL 2 (relay) | SIL 2 (4-20 mA and/or relay) |
| Analog out active (IS) | C | SIL 2 (4-20 mA and/or relay) | SIL 2 (4-20 mA and/or relay) | No |
| Analog out active (non-IS) | A | SIL 2 (4-20 mA and/or relay) | SIL 2 (4-20 mA and/or relay) | No |
| Analog out passive (IS) | D | SIL 2 (4-20 mA and/or relay) | SIL 2 (relay) or SIL 3 (relay) | No |
| Analog out passive (non-IS) | B | SIL 2 (4-20 mA and/or relay) | SIL 2 (4-20 mA and/or relay) | No |
| None | 0 | SIL 2 (relay) | SIL 2 (relay) | No |
| Ready for upgrade | F | SIL 2 (4-20 mA and/or relay) | SIL 2 (4-20 mA and/or relay) | No |

SIL = Primary Fieldbus and Secondary Fieldbus can be combined with SIL

No = Combination not possible

Integral display output variables

The integral digital read-out display can toggle between:

- Level
- Level rate
- Ullage
- Signal strength
- Volume (TOV)
- Liquid average temperature
- 1-16 spot temperature
- Vapor average temperature
- Ambient temperature
- Free water level
- Vapor pressure
- Liquid pressure
- Air pressure
- Observed density
- Reference density
- Flow rate

Display output units

Level, free water level, and ullage:

meter, millimeter, feet, or imperial 1/16

Level rate:

meter/second, meter/hour, feet/second, or feet/hour

| | |
|-------------------------------------|--|
| Flow rate: | meter ³ /hour, liter/minute, barrel/hour, or US gallon/hour |
| Total Observed Volume (TOV): | meter ³ , liters, barrel, or US gallon |
| Temperature: | °F, °C, or °K |
| Pressure: | psi, psiA, psiG, bar, barA or barG, atm, Pa, or kPa |
| Density: | kg/m ³ , °API, or 60/60DegF |
| Signal strength: | mV |

Density, mass, and more volume parameters are calculated in Rosemount TankMaster (GOV, GSV, NSV, WIA/WIV).

Configuration tools

Rosemount TankMaster

Autoconfiguration support

Yes (Tankbus addressing)

Electrical specifications

Power supply (nominal values)

24-48 Vdc (-15% to +10%) 48-240 Vac (-15% to +10%), 50/60 Hz

Power consumption

Max. 20 W depending on configuration.

Recommended Miniature Circuit Breaker (MCB): 2A slow

Tankbus cabling

0.5-1.5 mm² (AWG 22-16), twisted shielded pairs. Recommended cabling is shielded twisted pairs, 0.75 mm² (AWG 18). Tankbus cabling must fulfill FISCO cable and installation requirements, and must also be approved for use at minimum 85 °C (185 °F).

FISCO (Fieldbus Intrinsically Safe Concept)

The following cable characteristics are specified for FISCO:

Table 4: FISCO Cable Parameters

| Parameter ⁽¹⁾ | Value |
|---|---|
| Loop resistance | 15 Ω/km to 150 Ω/km |
| Loop inductance | 0.4 mH/km to 1 mH/km |
| Capacitance | 45 nF/km to 200 nF/km |
| Maximum length of each spur ⁽²⁾ cable | 60 m in apparatus class IIC and IIB |
| Maximum cable length including trunk ⁽³⁾ and spurs | 1000 m in apparatus class IIC and 1900 m in apparatus class IIB |

(1) For further information see requirements of the IEC 61158-2 standard.

(2) A spur is an unterminated part of the network.

(3) A trunk is the longest cable path between two devices on the fieldbus network, and is the part of the network which has terminations at both ends. In the Rosemount Tank Gauging system, a trunk is typically located between the Rosemount 2410 Tank Hub and a segment coupler or the last device in a daisy-chain configuration.

Power budget

Table 5: Power Consumption for Various Rosemount Tank Gauging Devices

| Field device | Power consumption |
|---|--|
| Rosemount 5900S Radar Level Gauge | 50 mA |
| Rosemount 5900C Radar Level Gauge | 50 mA |
| Rosemount 5900S Radar Level Gauge, 2-in-1 solution | 100 mA |
| Rosemount 5300 Level Transmitter | 21 mA |
| Rosemount 5408 Level Transmitter | 21 mA |
| Rosemount 2230 Graphical Field Display | 30 mA |
| Rosemount 2240S Multi-input Temperature Transmitter | 30 mA including 565, 566 and 765 temperature sensors |
| Rosemount 3144P Temperature Transmitter | 12 mA |
| Rosemount 3051S, and Rosemount 2051 Pressure Transmitters | 18 mA |

Allowed cabling distances

Figure 13: Cable Distances

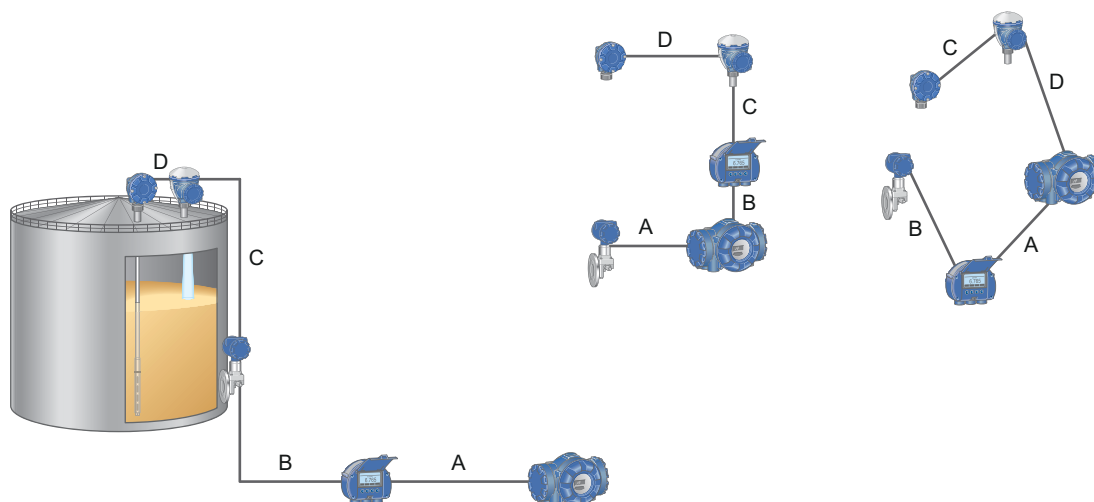

The total cable distance A+B+C+D must not exceed the values given in [Table 6](#).

Table 6: Allowed Cabling Distances for Different System Configurations

| Cable diameter | Loop resistance | Maximum cabling distance from power source to all devices on the tank | | |
|--------------------------------|-----------------|---|--|---|
| | | With maximum power usage of 250 mA Distance in m (ft) | With typical power usage of 128 mA for 5900S, 2240S, 2230, 3051S Distance in m (ft) | With typical power usage of 178 mA for 5900S 2-in-1, 2240S, 2230, 3051S Distance in m (ft) |
| 20 AWG (0.5 mm ²) | 66 Ω/km | 212 (695) | 414 (1358) | 298 (978) |
| 18 AWG (0.75 mm ²) | 42 Ω/km | 333 (1092) | 651 (2136) | 468 (1535) |
| 17 AWG (1.0 mm ²) | 33 Ω/km | 424 (1391) | 829 (2720) | 596 (1955) |
| 16 AWG (1.5 mm ²) | 26 Ω/km | 538 (1765) | 1000 (3281) | 756 (2480) |

The typical cabling distance from the tank hub toward the control room is up to 4 km (2.5 miles) depending on which protocol is used.

Power and relay cabling

0.5-2.5 mm² (AWG 22-14), twisted shielded pairs

Maximum Tankbus cable lengths

Depends on the cable. For details, see the Rosemount Tank Gauging [System Data Sheet](#).

Built-in Tankbus terminator

The Rosemount 2410 Tank Hub has a built-in tank bus terminator, which can be disconnected if required.

Mechanical specifications

Housing material

Polyurethane-covered die-cast aluminum

Cable entry (connection/glands)

Non-IS side: Two $\frac{1}{2}$ - 14 NPT and Two $\frac{3}{4}$ - 14 NPT entries for cable glands or conduits

IS side: Two $\frac{1}{2}$ - 14 NPT entries for cable glands or conduits

Three metal plugs to seal any unused ports are included in the delivery

Optional:

- M20 x 1.5 and M25 x 1.5 conduit/cable adapter
- Cable glands in metal ($\frac{1}{2}$ - 14 NPT and $\frac{3}{4}$ - 14 NPT)
- 4-pin male eurofast connector or A size Mini 4-pin male minifast connector

Installation

Can be installed on a 33.4-60.3 mm (1-2 in.) diameter pipe or wall, at ground level close to the tank or on top of the tank using existing cabling.

Weight

4.7 kg (10.4 lbs)

Environmental specifications

Temperature limits

Ambient temperature

-40 to 70 °C (-40 to 158 °F). Minimum start-up temperature is -50 °C (-58 °F).

With LCD display: -25 to 70 °C (-13 to 158 °F)

Storage temperature

-50 to 85 °C (-58 to 185 °F)

With LCD display: -40 to 85 °C (-40 to 185 °F)

Humidity

0 - 100% relative humidity

Ingress protection

IP 66 and IP 67 (NEMA® 4X)

Metrology sealing possibility

Yes

Write-protect switch

Yes (hardware and software write-protection)

Transient/built-in lightning protection

In accordance with IEC 61000-4-5, level 4 kV line to ground.

Specifications for Emerson Wireless 775 THUM Adapter Assembly

Note

For more information, see the Emerson Wireless 775 THUM Adapter [Product Data Sheet](#).

General specifications

The THUM Adapter allows *WirelessHART*® communication according to the IEC 62591 standard between the Rosemount 2410 Tank Hub and the Emerson Wireless Gateway. The THUM is integrated with a connection box.

Transmission range

Application dependent. Consult factory

Communication specifications

Communication protocol

IEC 62591 (*WirelessHART*®)

Radio characteristics

- Standard IEEE 802.15.4 radio
- 2.4 GHz ISM band sliced into 16 radio-channels
- Continually “hop” across channels to avoid interference and increase reliability
- Direct sequence spread spectrum (DSSS) delivers high reliability in challenging radio environment

Update rate

User selectable, eight seconds to 60 minutes

Electrical specifications

Power supply

Powered by Rosemount 2410 Tank Hub

Output cabling

Shielded twisted pair wiring, 0.5-2.5 mm² (AWG 22-14)

Maximum cable length depends on cable characteristics.

Mechanical specifications

Materials of construction

Housing/enclosure

Polyurethane painted, low-copper aluminum housing

Antenna

Polybutadine terephthalate (PBT)/polycarbonate (PC) integrated omnidirectional antenna

Cable entry (connection/glands)

One M20 x 1.5 entry for cable gland or conduit adapter

Optional:

- Metal cable gland M20 x 1.5
- ½ NPT adapter (female thread)

Installation

The THUM Adapter can be installed on a vertical or horizontal 1- to 2-in. pipe, away from the tank hub at the best possible tank roof position. It should be installed approximately 2 m (6 ft) or more from any large structure or conductive surface.

Weight

Connection box and THUM Adapter: 2.0 kg (4.4 lbs.)

Environmental specifications

Temperature limits

Ambient temperature

-40 to +185 °F (-40 to +85 °C)

Storage temperature

-40 to +185 °F (-40 to +85 °C)

Humidity limits

0 - 100 percent relative humidity

Ingress protection

IP 66 and NEMA 4X

Product certifications

See the Rosemount 2410 [Product Certifications](#) document for detailed information on the existing approvals and certifications.

See the Emerson 775 [Quick Start Guide](#) for detailed information on the existing approvals and certifications.

Dimensional drawings

Figure 14: Rosemount 2410 Tank Hub Dimensions

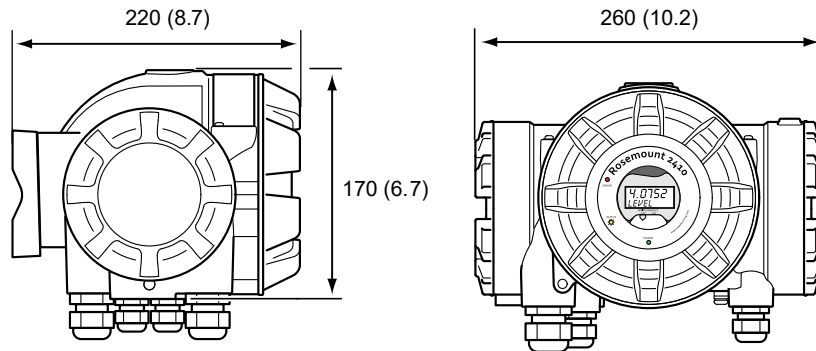

Dimensions are in millimeters (inches).

Figure 15: Rosemount 2410 Tank Hub Mounting

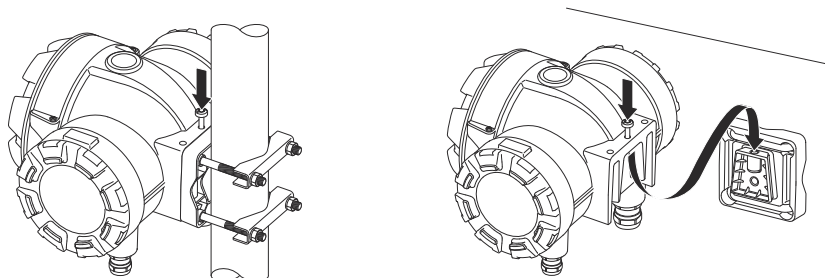

Rosemount 2410 can be mounted on a wall or a pipe with 33.4-60.3 mm (1-2 in.) diameter.

Figure 16: Emerson Wireless 775 THUM Adapter Assembly Dimensions

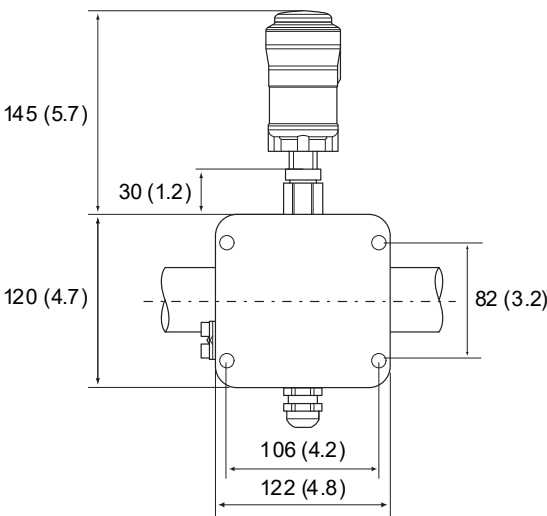

Dimensions are in millimeters (inches).

Figure 17: Emerson Wireless 775 THUM Adapter Assembly Mounting

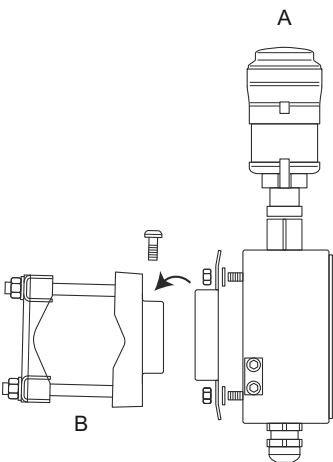

- A. Vertical orientation of THUM Adapter
- B. Mounting kit for vertical or horizontal installation; fits 33.4-60.3 mm (1-2 in.) pipe diameter

For more information: [Emerson.com/global](https://emerson.com/global)

©2024 Emerson. All rights reserved.

Emerson Terms and Conditions of Sale are available upon request. The Emerson logo is a trademark and service mark of Emerson Electric Co. Rosemount is a mark of one of the Emerson family of companies. All other marks are the property of their respective owners.

ROSEMOUNT™

