

KEP 332 PUMP



Applications:

- Cutting, turning, milling, boring, grinding and similar applications of the machine tools,
- Filtration systems,
- Circulation systems.
- KEP Pumps are used for pumping of cutting / cooling fluids.

Fluid Specifications:

- Coolants,
- Cutting oils,
- Grinding oils,
- Water
- Chip containing liquids (max. 5 mm)
- Fluid temperature 0...60 °C
- Kinematic viscosity 1...30 mm²/s

Materials:

Pump body	: Cast iron - DIN GG25
Motor Flange	: Cast iron - DIN GG25
Impeller	: Cast iron - DIN GG25
Shaft	: Stainless steel - AISI 420 (DIN 1.4021)
Mechanical Seal	: SiC-SiC-Viton
Electric motor	: 3 phase induction motor 2 pole, 3000 rpm Protection degree IP 54

Suction Head and Priming Time

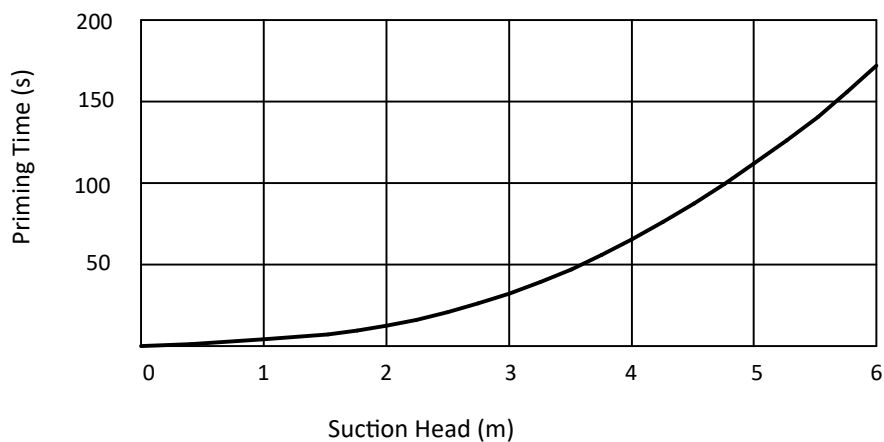

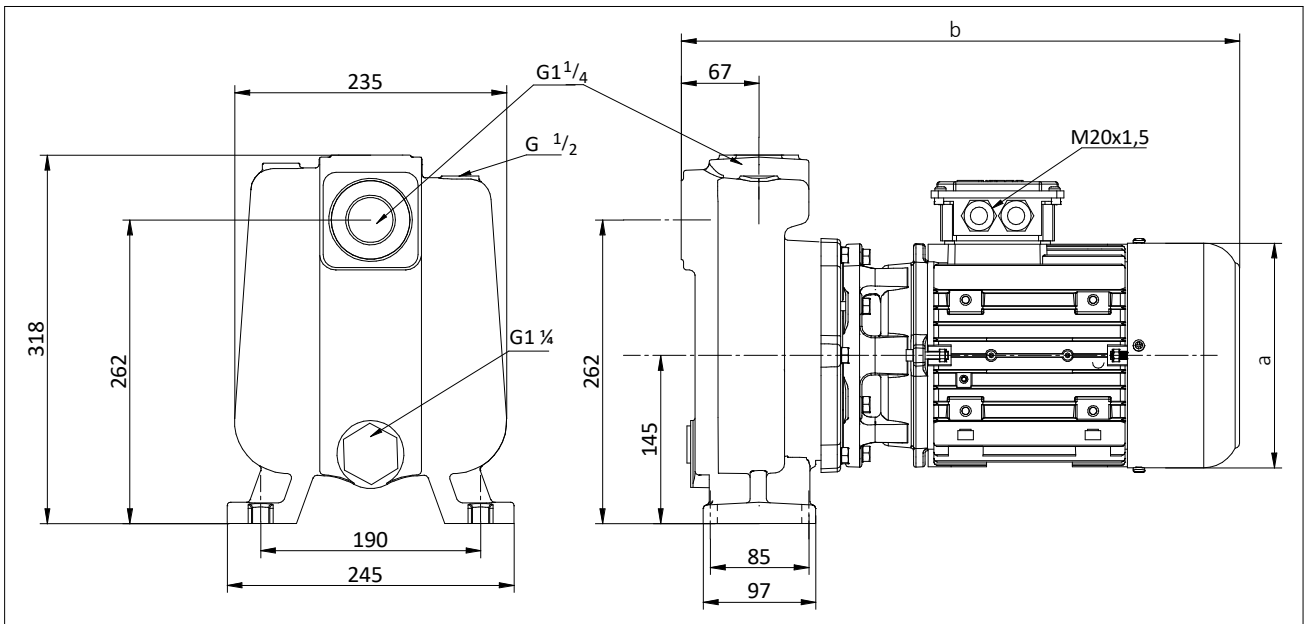

DIMENSIONS & NOMINAL VALUES

TYPE	mm		Weight	Power	Voltage	Frequency	Rated current	Speed
	a	b	kg	kW	V(Δ/Y)	Hz	A	rpm
KEP 332/136	176	425	34	1.5	230/400	50	5.72/3.3	2910
KEP 332/150		445	37	2.2			7.79/4.5	2905
KEP 332/160	195	478	43	3.0			10.39/6.0	2905
KEP 332/170			45	4.0			13.68/7.9	2900

* The performance curves are based on 1 mm²/s (cSt) kinematic viscosity values and 1000 kg/m³ density

** Curve tolerance according to EN ISO 9906.

Performance Curve

