

KOMBITRAK 800

Coil and spool unwinder, manual

For heavy coils and spools



Fig. 1 KOMBITRAK 800 T with coiler head RAPID 800 SL

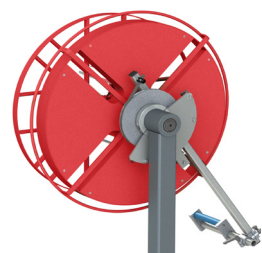

Fig. 2: Back side KOMBITRAK 800 T



Fig. 3: Back side KOMBITRAK 800 B

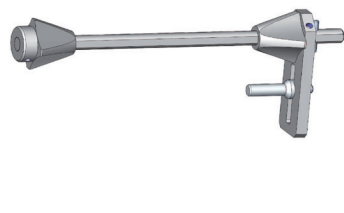

Fig. 4: Spool winding axle 800 MB

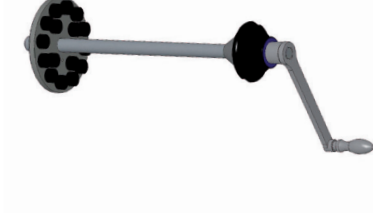

Fig. 5: Spool winding axle 800 RM

KOMBITRAK 800

- Coil and spool unwinder with mechanical break or pendulum with rope break

Functionality:

This manual coil and spool unwinder enables to pull off material like cables, wires etc. from coils or spools. Adjustable break mechanism avoid an uncontrolled material flow.

- Twisting-free pull off of the winding material
- Adjustable break mechanism avoid an uncontrolled material flow
- Coiler head according to coil dimensions
- Easy assembly and removal of the coils and spools
- Continuous and central tension of the coils

KOMBITRAK 800

Coil and spool unwinder, manual

Base frame

Technical data	KOMBITRAK 800 B	KOMBITRAK 800 T
Part No.	87000305	85100912
Break mechanism	with mechanical break	with pendulum and mechanical break
Winding head Ø	max. 800 mm	max. 800 mm
Spool Ø	max. 800 mm	max. 800 mm
Spool/ Coil width	according to specification of the winding axle / coiler head	according to specification of the winding axle / coiler head
Locating bore	30 mm	30 mm
Loading weight	max. 100 kg	max. 100 kg
L x W x H	approx. 1200 x 1000 x 1000 mm	approx. 1200 x 1000 x 1000 mm
Weight	approx. 70 kg	approx. 70 kg
Colour	RAL 7005 mouse grey	RAL 7005 mouse grey
Running direction	from right to left	from right to left

Coiler head

Technical data	RAPID 480 SL	RAPID 800 SL
Part No.	85100082	85100101
Coil-Ø	max. 480 mm	max. 800 mm
Core range continuously adjustable	200-370 mm	300-550 mm
Coil width	50-250 mm	50-250 mm
Loading capacity	max. 65 kg	max. 80 kg
Axle holder Ø	30 mm	30 mm
Weight	approx. 40 kg	approx. 70 kg
Colour	RAL 3020 traffic red	RAL 3020 traffic red

Spool winding axle

Technical data	Spool winding axle 800 MB	Spoolwinding axle 800 RM
Part No.	85100103	87000224
Spool Ø	max. 800 mm	max. 800 mm
Spool width	max. 250 mm	max. 405 mm (at bore hole 35 mm) max. 415 mm (at bore hole 50 mm) max. 445 mm (at bore hole 85 mm)
Core hole of the spool	40-80 mm	35-85 mm
Axle holder Ø	30 mm	30 mm
Axle Ø	30 mm	30 mm
Axle length	600 mm	
Loading weight	max. 60 kg	max. 100 kg
Weight	approx. 8 kg	approx. 10 kg

Indoor use only. Fig. may differ from original.
Technical modifications reserved. Status: 01/2020