

Spindle ball bearings (HY)* S 61920 C

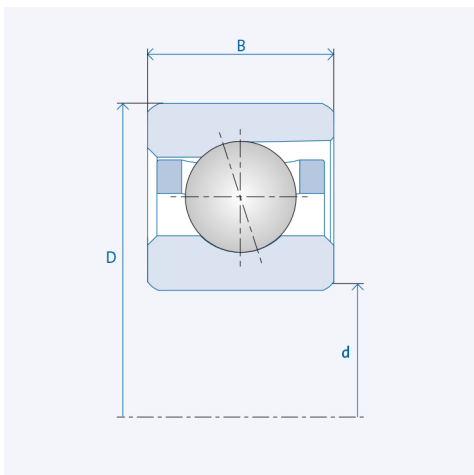

Precision class P4 / ABEC7

Components

Bearing designation:	(HY)* S 61920 C
Bearing design:	S
Series / size:	61920
Ball material:	Steel 100Cr6
Ball material HY :	Ceramic Si3N4
Cage:	TA (TXM available upon request)
Precision:	P4 (HG, UP, P2 upon request)
Main dimensions [d x D x B]:	100 x 140 x 20 mm

Technical data (Standard bearings)

Static load capacity C_0 :	57000
Dynamic load capacity C:	51500
Speed limit n_{Fett} :	10500
Speed limit n_{Oj} :	14000

Technical data (Hybrid bearings)*

Static load capacity C_{0HY} :	40500
Dynamic load capacity C_{HY} :	51500
Speed limit n_{Fett} :	13125
Speed limit n_{Oj} :	17500

Pre-tension

Light (L):	260 N
Axial rigidity (C_{ax}):	100 N/ μ m
Medium (M):	790 N
Axial rigidity (C_{ax}):	162 N/ μ m
Heavy (S):	1570 N
Axial rigidity (C_{ax}):	226 N/ μ m
Spring preload (Ff):	1320 N

The given speed limits apply to individual bearings with spring preload. Correction factors must be considered for all properties which deviate from this.

* All ball bearings are also available as hybrid ball bearings (HY).