

PXF

Vertical or Horizontal Mount Screw Pumps

Shanley Pump  
& Equipment, Inc.



# PXF

## Features

The SEIM PXF series of indoor/outdoor screw pumps is ideal for use in pressure pumping applications of viscous fluids in hydraulic and lubrication systems in both Marine and Industrial applications.

## Description

Its solid construction with a mechanical seal will provide years of steady service. Ideal for continuous duty up to 30 bar (435 PSI). The SEIM PXF Series operates at 5 to 55 GPM at a temperature range of 32° to 302° F







SEIM screws pumps are positive displacement volumetric self-priming pumps suited to handle various oils and fluids with a minimum lubricating property. The pumps design and manufacturing quality makes them intrinsically reliable for long service life and efficient in their applications.

## Usage

The SEIM PXF series Screw Pump is ideal for:

Separator Pumping  
Transfer Pumping  
Booster Pumping  
Feeder Supply Pumping  
Fuel Oil Supply Pumping  
Lubrication Systems

## Main Applications

-  Marine Pumping
-  Oils Pumping
-  High Viscosity Fluids Pumping
-  Plant Engineering Pumping
-  Fuel Oil Pumping Applications
-  Viscous Fluids Pumping Applications
-  Lubrication Systems Applications

**GPM** 5 - 55 GPM

**PSI** 0 - 435 PSI

**TEMP** -13°F - +230°F

- 1.) Mechanical Seal or Radial Seal
- 2.) Cast Iron/Steel Motor Connection Flange
- 3.) Carbon Steel Driving Spindle
- 4.) Key
- 5.) Inspection Flange
- 6.) Gasket
- 7.) Ball Bearing
- 8.) Carbon Steel Idler Spindle
- 9.) Cast Iron Pump Casing
- 10.) Gasket
- 11.) Cast Iron Axial Inlet Flange
- 12.) Cast Iron Radial Inlet Flange

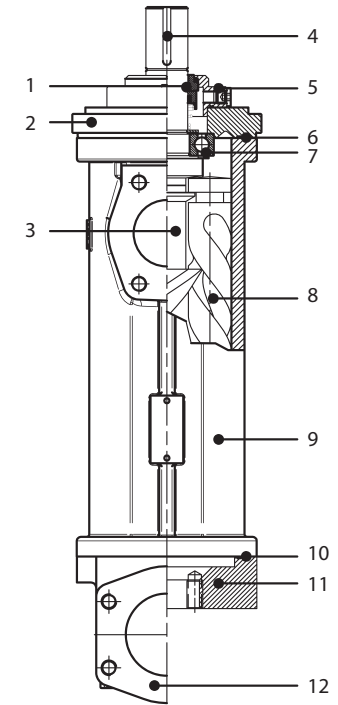

[Dimensions Drawings](#)

[Click here for complete dimensional drawings](#)



### Performance Curve

For specific applications data on viscosity and pressure please contact us and we send you details about flow rates.